

NARITAA



PRODUCT CATALOGUE

CNC SPINDLE
TOOL HOLDING SYSTEMS
& BORING BARS



About Us

Naritaa manufactures standard and customized tool holders for CNC Machining Centres. We also manufacture customized tools for boring, drilling and milling applications.

As an ISO 9001:2015 certified company, Naritaa was established in the year 2014 in Coimbatore and expands product ranges in short span of time and renowned as a major tooling partner to our customers.

Our Mission:

‘To expand and continually improve utilizing quality practice and employee involvements to manufacture tools and products for the industry worldwide that result in customer satisfaction and delight.’

We firmly believe our growth is directly dependable on Customer focus, Customer satisfaction and Customer delight. To work on above, we continually extend our quality, product ranges, machining capacity in terms of investment and with pool of talented employees in all departments including R&D.

Product Ranges

Range of Tapers:

BT | HSK | CAT | SK | ISO | BBT | VDI | Trevisan | Youji | Yu Shine | HNK VTL | FEMCO | NT

Range of Holders:

- Hydro-grip Holders
- Shrink-Fit Holders
- Collet Chuck Holders
- Side Lock Holders
- Face Mill Holders
- Morse-Taper Holders
- Side & Face Cutter Holders
- Combi Shell Mill Holders
- Run-Out Adjustable Holders
- Test Mandrel
- Blank Adaptors
- Drill Chuck Holders
- Thread Coupling Milling Holders

- Modular Finish Boring Bar with 10 microns adjustable Fine Boring Unit in range of $\varnothing 25 - \varnothing 800$.
- Modular adjustable Rough Boring Bar in range of $\varnothing 25 - \varnothing 800$
- U-Drills in L/D up to 4
- Special Combination Boring Bars with ISO Cartridges
STFCR/L, STWCR/L, STSCR/L,
STTCR/L, STGCR/L, STRCR/L.
- Special Milling cutters
- Chamfering tools, Spot Facing Tools

CNC Accessories:















- Pull Studs,
- Boring Sleeves
- ER Collets
- Tool Clamping Devices
- ER Spanners and Coolant Tubes

Mechanical, Hydraulic and Pneumatic Jigs & Fixtures



ISO Certificate



1 <i>Taper Details</i> 		3 <i>BBT</i> 		10 <i>HSK</i> 
	18 <i>BT</i> 		28 <i>Boring Bars</i> 	
32 <i>YOUJI-VTL</i> 		34 <i>TREVISAN</i> 		36 <i>All Hydraulic</i> 
C O N T E N T S	40 <i>Accessories</i> 		41 <i>Pull Stud</i> 	
		43 <i>COLLET</i> 		44 <i>Baby Collet Chuck</i> 
	45 <i>Shrink Fit Extension</i> 		46 <i>Customized Tools</i> 	





TAPER DETAILS

DIN 69893-1 HSK

Tapers available in NARITAA

FORM - A

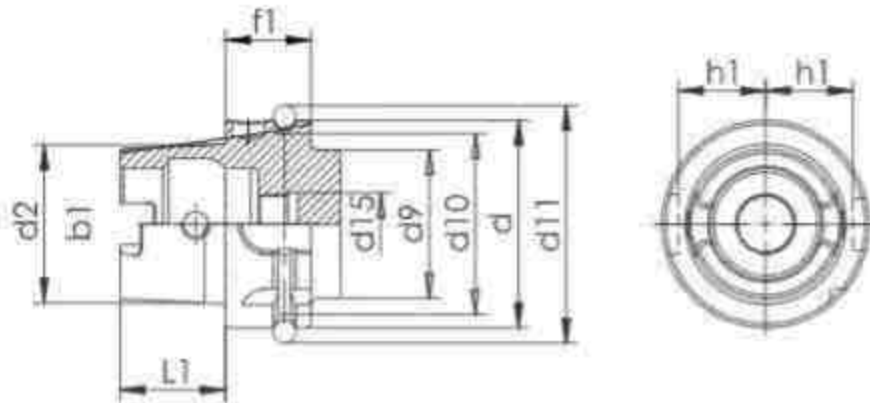

HSK - d	b1±0.04	d2	d9 max	d10 -0.1	d11 -0.1	d15	f1 -0.1	h1-0.2	H -0.2
50	10.54	38.009	40	43	59.3	M16x1	26	21	25
63	12.54	48.010	50	55	72.3	M18x1	26	26.5	32
100	20.02	75.013	80	92	109.75	M24x1.5	29	44	50

Note: DIN 69893-1 HSK Form-B,C,D,E,F. Tool Holders are Available on Request

BT MAS 403 (JIS B 6339)

Form - A

Form - AD+B

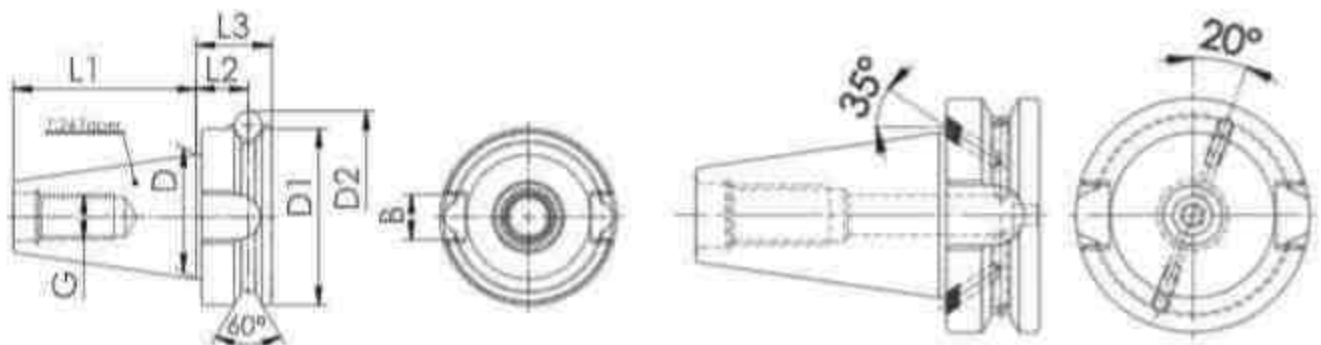

Taper ISO	D	D1	D2	L1	L2	L3	B	G
30	31.75	46.0	56.14	48.4	13.6	22	16.1	M12
40	44.45	63.0	75.68	65.4	16.8	27	16.1	M16
50	69.85	100.0	119.02	101.8	23.2	38	25.7	M24



SK - DIN 69871

Form - A

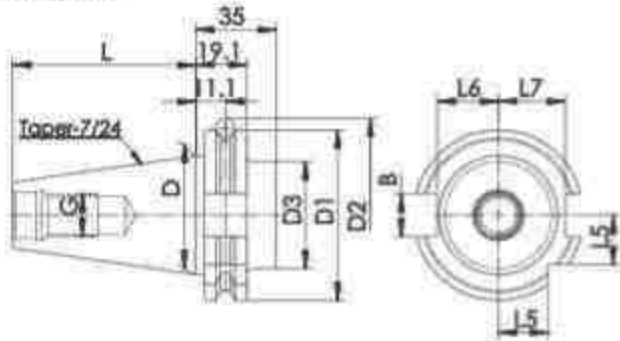

Form - AD+B

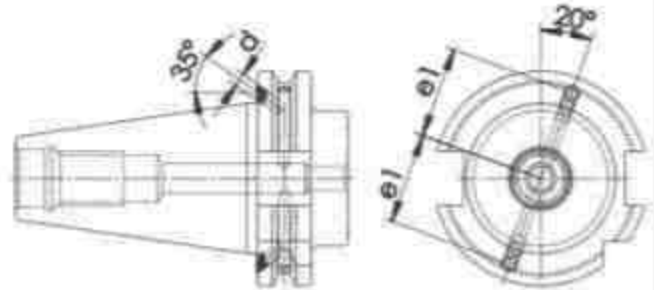

Taper ISO	D	D1	D2	D3	L	L5	L6	L7	B	G	d	e1
40	44.45	63.55	72.35	50.0	68.4	18.5	22.8	25	16.1	M16	4	27
50	69.85	97.50	107.3	80.0	101.6	30	35.5	37.7	25.7	M24	6	42

DIN-2080

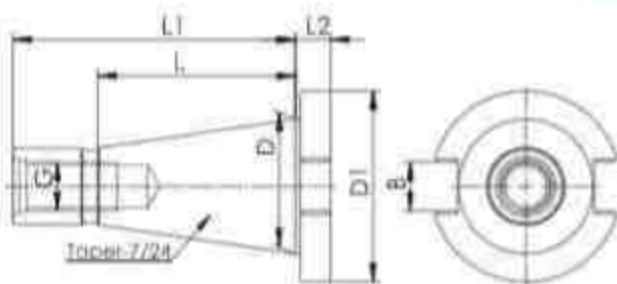

CAT / ANSI B5.50

Form - A

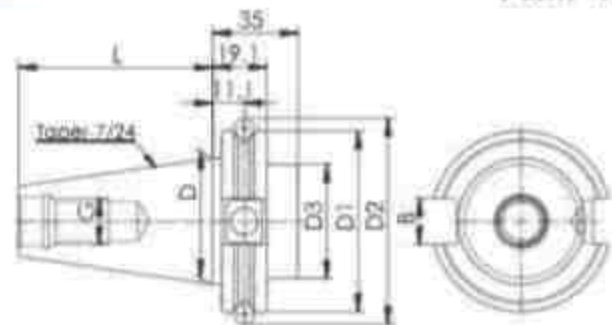

Taper ISO	D	D1	L	L1	L2	B	G
30	31.75	50	48.4	68.4	9.6	16.1	M12
40	44.45	63	65.4	93.4	11.6	16.1	M16
50	69.85	100	103.0	128.0	15.2	25.7	M24

Taper ISO	D	D1	D2	D3	L	B	G
40	44.45	63.55	72.35	44.7	68.4	16.38	5/8-11
50	69.85	98.43	107.64	70.1	101.6	25.91	1"8

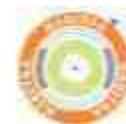

BBT - Dual Contact Tool Holders

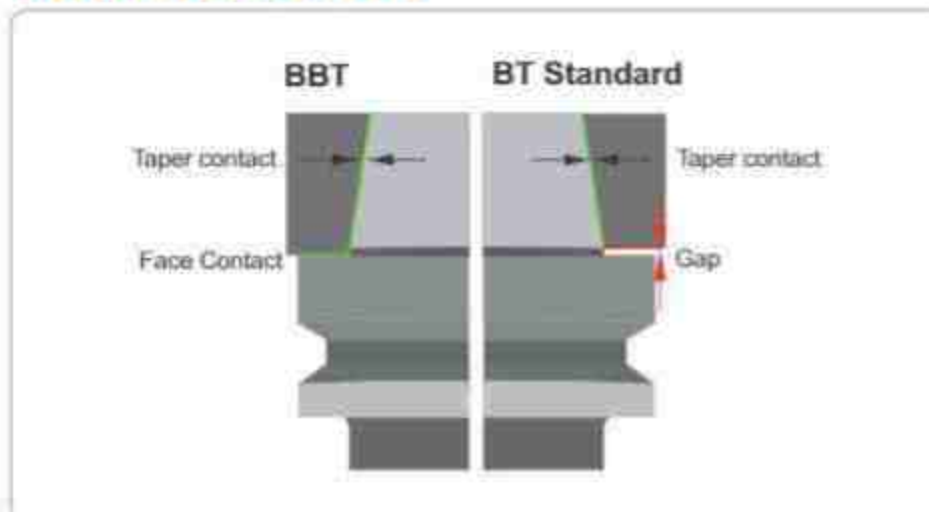

Collet Chuck Holder - Standard Length	4
Collet Chuck Holder - Extra Length	5
Side Lock Holder - Standard Length	6
Side Lock Holder - Extra Length	7
Face Mill Holder - Through Coolant	8
Morse Taper Adapter - Tanged End	9

Overview of BBT

BBT - Dual contact system means both taper contact and face contact between flange of tool holder and spindle face.

Advantages of BBT over BT

- Increased contact diameter by flange results to more rigidity for extra length tool holder & tool
- Good surface finish
- Excellent choice for high speed machining
- Prevention of fretting corrosion
- Eliminating Z-axial movement during high speed machining

BBT - Dual Contact Collet Chuck Holder DIN 6499 - Standard Length

Form - AD

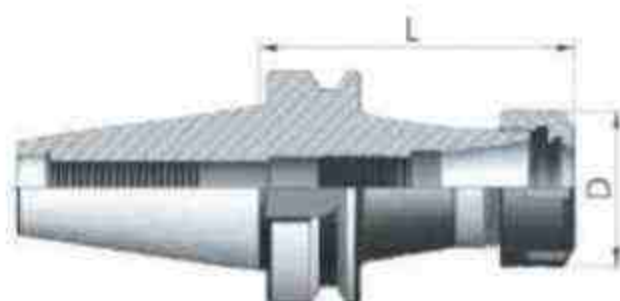

Taper	Ordering Code	Suitable Collet	Clamping Range	L	D	Spanner	Wt. in Kgs.
30	516.030.01.016.070	ER 16	1-10	70	28	611.07.16	0.5
	516.030.01.020.070	ER 20	1-13	70	34	611.07.20	0.6
	516.030.01.025.070	ER 25	1-16	70	42	611.07.25	0.7
	516.030.01.032.070	ER 32	2-20	70	50	611.07.32	0.7
40	516.040.01.011.070	ER 11	1-7	70	19	611.07.11	1
	516.040.01.016.070	ER 16	1-10	70	28	611.07.16	1.1
	516.040.01.020.070	ER 20	1-13	70	34	611.07.20	1.1
	516.040.01.025.070	ER 25	1-16	70	42	611.07.25	1.2
	516.040.01.032.070	ER 32	2-20	70	50	611.07.32	1.2
	516.040.01.040.070	ER 40	3-26	70	63	611.07.40	1.3
50	516.050.01.050.100	ER 50	10-34	100	78	611.07.50	2.1
	516.050.01.016.080	ER 16	1-10	80	28	611.07.16	3.7
	516.050.01.020.080	ER 20	1-13	80	34	611.07.20	3.7
	516.050.01.025.080	ER 25	1-16	80	42	611.07.25	3.8
	516.050.01.032.080	ER 32	2-20	80	50	611.07.32	3.7
	516.050.01.040.080	ER 40	3-26	80	63	611.07.40	3.8
	516.050.01.050.100	ER 50	10-34	100	78	611.07.50	4.4

Flange through coolant, Special Designs, Sizes and Mini nut ER8, ER11, ER16, ER20, ER25 collet chuck are available on Request. Spanner order Separately.

Accessories



Pull Stud

Collet

Collet Nut

Stopper Screw

Spanner



BBT - DUAL CONTACT

Collet Chuck Holder DIN 6499 - Extra Length

Form - AD



Taper	Ordering Code	Suitable Collet	Clamping Range	L	D	Spanner	Wt. in Kgs.
40	516.040.01.016.105	ER16	1-10	105	28	611.07.16	1.2
	516.040.01.016.150	ER16	1-10	150	28	611.07.16	1.3
	516.040.01.020.105	ER20	1-13	105	34	611.07.20	1.2
	516.040.01.020.150	ER20	1-13	150	34	611.07.20	1.4
	516.040.01.025.105	ER25	1-16	105	42	611.07.25	1.4
	516.040.01.025.150	ER25	1-16	150	42	611.07.25	1.7
	516.040.01.032.100	ER32	3-20	100	50	611.07.32	1.5
	516.040.01.040.100	ER40	4-26	100	63	611.07.40	1.8
50	516.050.01.016.135	ER16	1-10	135	28	611.07.16	4
	516.050.01.016.150	ER16	1-10	150	28	611.07.16	3.8
	516.050.01.020.135	ER20	1-13	135	34	611.07.20	4.2
	516.050.01.020.150	ER20	1-13	150	34	611.07.20	4
	516.050.01.025.135	ER25	1-16	135	42	611.07.25	4.1
	516.050.01.025.150	ER25	1-16	150	42	611.07.25	4.4
	516.050.01.032.135	ER32	3-20	135	50	611.07.32	4.3
	516.050.01.040.135	ER40	4-26	135	63	611.07.40	4.6

Note: Flange through coolant, Special Designs, Sizes and Mini nut ER8, ER11, ER16, ER20, ER25 collet chuck are available on Request. Spanner order Separately.

Accessories



Pull Stud

Collet

Collet Nut

Stopper Screw

Spanner



BBT - Dual Contact Side Lock Holder - Standard Length

Form - AD



Taper	Ordering Code	d	D	L	WL in Kgs.
30	516.030.02.008.065	8	24	65	0.5
	516.030.02.010.065	10	30	65	0.6
	516.030.02.012.065	12	35	65	0.6
	516.030.02.016.065	16	40	65	0.7
	516.030.02.020.090	20	50	90	1.2
	516.030.02.025.090	25	50	90	1.1
40	516.040.02.008.065	8	24	65	1
	516.040.02.010.065	10	30	65	1.2
	516.040.02.012.065	12	35	65	1.2
	516.040.02.016.065	16	40	65	1.3
	516.040.02.020.090	20	50	90	1.4
	516.040.02.025.090	25	50	90	2.4
	516.040.02.032.090	32	60	90	2.6
	516.040.02.040.090	40	63	90	3.1
50	516.050.02.008.070	8	28	70	3.7
	516.050.02.010.070	10	35	70	3.8
	516.050.02.012.080	12	42	80	4
	516.050.02.016.080	16	48	80	4
	516.050.02.020.080	20	52	80	4.1
	516.050.02.025.105	25	65	105	4.9
	516.050.02.032.105	32	72	105	5.1
	516.050.02.040.120	40	80	120	5.8
516.050.02.050.125	50	100	125	7	

Accessories



Pull Stud



Grub Screw



Stopper Screw

Note: Special Designs and Sizes are Available on Request



BBT - Dual Contact

Side Lock Holder - Extra Length

Form - AD

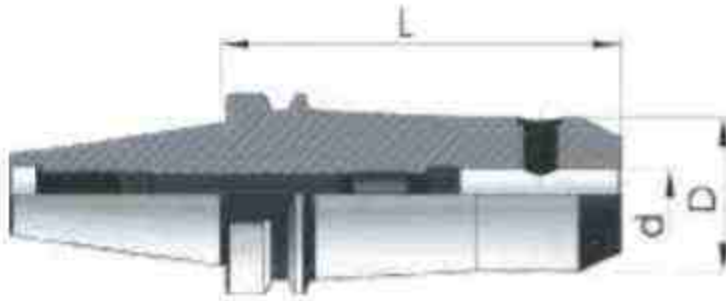

Taper	Ordering Code	d	D	L	WL in Kgs.
40°	516.040.02.008.125	8	24	125	1.4
	516.040.02.010.125	10	27	125	1.7
	516.040.02.012.125	12	32	125	2
	516.040.02.016.125	16	36	125	2.1
	516.040.02.020.125	20	45	125	2.3
	516.040.02.025.125	25	45	125	3
	516.040.02.032.125	32	54	125	3.15
	516.040.02.040.125	40	60	125	3.5
50°	516.050.02.008.150	8	24	150	4.2
	516.050.02.010.150	10	27	150	4.5
	516.050.02.012.150	12	32	150	4.9
	516.050.02.016.150	16	30	150	5.1
	516.050.02.020.160	20	36	160	5.53
	516.050.02.025.160	25	45	160	6.5
	516.050.02.032.160	32	45	160	7
	516.050.02.040.160	40	65	160	7.4

Note : Special Designs and Sizes are Available on Request

Accessories



Pull Stud

Grub Screw

Stopper Screw



BBT - Dual Contact Face Mill Holder - Through Coolant

Form - AD

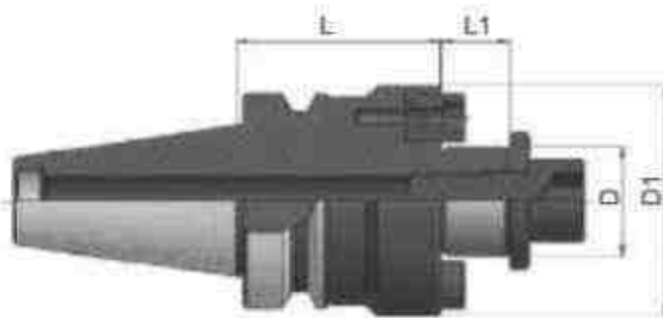

Taper	Ordering Code	D	L	L1	D1	Cutter Dia	WL in Kgs
30	516.030.03.016.050.TC	16	50	14	34	40	0.6
	516.030.03.022.050.TC	22	50	16	48	50 & 63	0.8
	516.030.03.027.050.TC	27	50	18	60	80	1.0
40	516.040.03.016.060.TC	16	60	14	34	40	1.2
	516.040.03.016.120.TC	16	120	14	34	40	1.7
	516.040.03.022.060.TC	22	60	16	48	50 & 63	1.5
	516.040.03.022.090.TC	22	90	16	48	50 & 63	1.9
	516.040.03.022.120.TC	22	120	16	48	50 & 63	2.3
	516.040.03.027.045.TC	27	45	18	60	80	1.4
	516.040.03.027.090.TC	27	90	18	60	80	2.4
	516.040.03.027.105.TC	27	105	18	60	80	2.7
	516.040.03.032.060.TC	32	60	20	70	100	2
	516.040.03.032.090.TC	32	90	20	70	100	2.7
	516.040.03.040.060.TC	40	60	23	80	125	2.5
50	516.050.03.040.075.TC	40	75	23	80	125	2.6
	516.050.03.022.075.TC	22	75	16	48	50 & 63	4.2
	516.050.03.022.120.TC	22	120	16	48	50 & 63	4.9
	516.050.03.027.060.TC	27	60	18	60	80	4.2
	516.050.03.027.105.TC	27	105	18	60	80	5.2
	516.050.03.032.060.TC	32	60	20	70	100	4.4
	516.050.03.032.090.TC	32	90	20	70	100	5.3
	516.050.03.040.060.TC	40	60	23	80	125	4.8
	516.050.03.040.105.TC	40	105	23	80	125	6.6

Special Designs: Inch size Facemill Holder and Flange through coolant are available on request

Accessories



Pull Stud

Driving Key

Allen Screw

Washer

Allen Screw

Grab Screw



BBT - Dual Contact Morse Taper Adapter - Tanged End

Form - AD

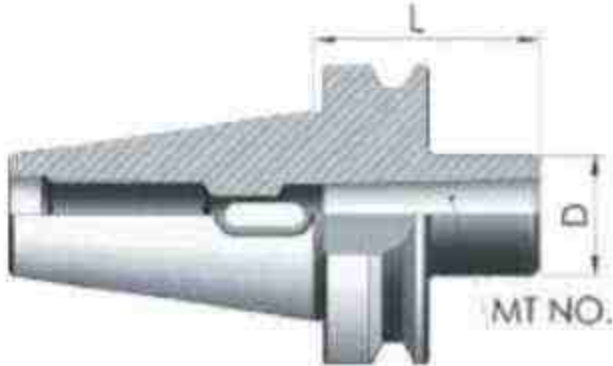

Taper	Ordering Code	MT No.	L	D	WL in Kgs.
30	516.030.04.001.050	1	50	25	0.4
	516.030.04.002.062	2	62	32	0.5
	516.030.04.003.080	3	80	40	0.7
40	516.040.04.001.045	1	45	25	1
	516.040.04.002.060	2	60	32	1
	516.040.04.003.075	3	75	40	1.1
	516.040.04.004.095	4	95	50	1.3
50	516.050.04.001.045	1	45	25	3.5
	516.050.04.002.045	2	45	32	3.4
	516.050.04.003.045	3	45	40	3.4
	516.050.04.004.075	4	75	50	3.5
	516.050.04.005.105	5	105	70	4

Note: Special Designs and Sizes are Available on Request

Accessories



Pull Stud



DIN 69893

HSK Tool Holders



Collet Chuck Holder - Standard Length	11
Collet Chuck Holder - Extra Length	12
Side Lock Holder - Standard Length	13
Side Lock Holder - Extra Length	14
Face Mill Holder - Standard & Extra Length	15
Face Mill Arbor - Flange Type Test Bar	16
Shrink Fit Holder	17

Overview of HSK

HSK tool holders are a German development with DIN standard DIN69893. The abbreviation HSK stands for "Hohl Shaft Kegel," which, literally translated into English, means "hollow-shank taper." HSK connection depends on a combination of axial clamping forces by internal machine draw bar and taper-shank interference. HSK shank has 1:10 taper ratio. HSK tool holder design with face contact allows for a much higher spindle RPM without causing 'bell mouching' as in BT series. There are total six HSK shanks which are differentiated in positions of the drive slots, gripper-location slots, coolant holes, and area of the flange. These shank styles are designated by the letters A through F. Each style was defined for certain applications.



HSK-A

DIN-69893 HSK-A

Collet Chuck Holder DIN 6499 - Standard Length

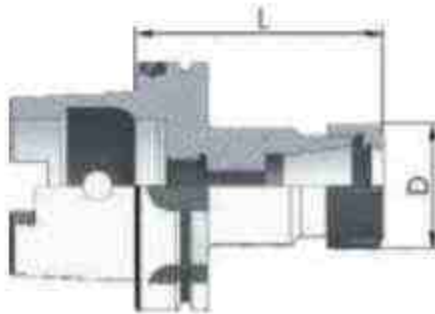

Taper	Ordering Code	D	L	Wt. in Kgs.
HSK A50	511.050.01.011.080	19	80	0.6
	511.050.01.016.080	28	80	0.6
	511.050.01.020.080	34	80	0.6
	511.050.01.025.080	42	80	0.6
	511.050.01.032.080	50	80	0.6
	511.050.01.040.090	63	90	1
HSK A63	511.063.01.011.080	19	80	0.7
	511.063.01.016.080	28	80	0.8
	511.063.01.020.080	34	80	0.8
	511.063.01.025.080	42	80	0.9
	511.063.01.032.080	50	80	1
	511.063.01.040.100	63	100	1.2
HSK A100	511.100.01.016.100	28	100	2.2
	511.100.01.020.100	34	100	2.4
	511.100.01.025.100	42	100	2.5
	511.100.01.032.100	50	100	2.7
	511.100.01.040.100	63	100	2.8
	511.100.01.050.100	78	100	3.3

Note:

Spanner Order Separately.

Special Designs and Sizes are Available on Request.

Coolant Tube and Coolant Tube Spanner order Separately.

Mini Nut collet chuck holder ER8, ER11, ER16, ER20, ER25 available.

Accessories



Coolant Tube

Coolant Tube Spanner

Collet

Collet Nut

Stopper Screw

Spanner



DIN-69893 HSK-A

Collet Chuck Holder DIN 6499 - Extra Length

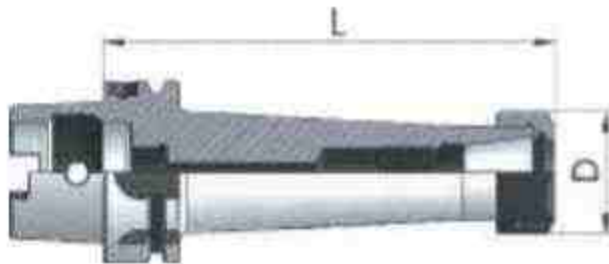

Taper	Ordering Code	D	L	Wt. in Kgs.
HSK A63	511.063.01.016.160	28	160	1.3
	511.063.01.020.160	34	160	1.5
	511.063.01.025.160	42	160	1.6
	511.063.01.032.160	50	160	1.9
	511.063.01.040.160	63	160	2.1
HSK A100	511.100.01.016.160	28	160	2.6
	511.100.01.020.160	34	160	2.8
	511.100.01.025.160	42	160	3
	511.100.01.032.160	50	160	3.2
	511.100.01.040.160	63	160	3.9

Note: Spanner Order Separately
 Special Designs and Sizes are Available on Request
 Coolant Tube and Coolant Tube Spanner order Separately
 Mini Nut collet chuck holder ER8, ER11, ER16, ER20, ER25 available.
 DIN 69893-1 HSK Form-B,C,D,E,F, Tool Holders are Available on Request

Accessories



Coolant Tube

Coolant Tube Spanner

Collet

Collet Nut

Stopper Screw

Spanner



HSK-A

DIN-69893 HSK-A

Side Lock Holder - Standard Length

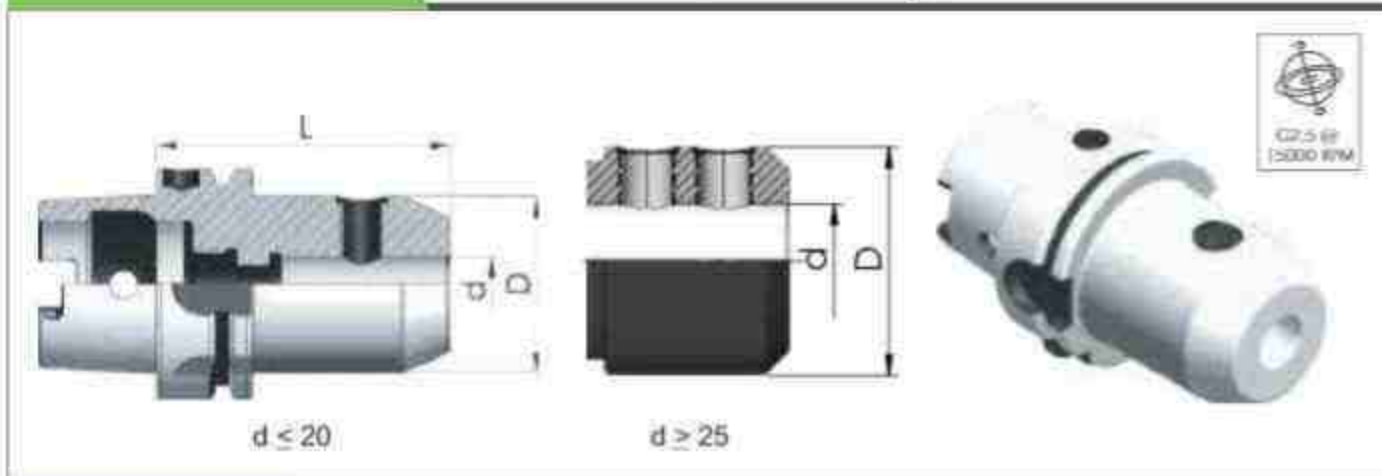

Taper	Ordering Code	d	D	L	Wt. in Kgs.
HSK A50	511.050.02.008.065	8	28	65	0.6
	511.050.02.010.065	10	35	65	0.8
	511.050.02.012.080	12	42	80	0.9
	511.050.02.016.080	16	48	80	1
	511.050.02.020.080	20	52	80	1
	511.050.02.025.110	25	65	110	1.8
	511.050.02.032.110	32	72	110	1.9
HSK A63	511.063.02.008.065	8	28	65	0.8
	511.063.02.010.065	10	35	65	0.9
	511.063.02.012.080	12	42	80	1.2
	511.063.02.016.080	16	48	80	1.3
	511.063.02.020.080	20	52	80	1.3
	511.063.02.025.110	25	65	110	2.3
	511.063.02.032.110	32	72	110	2.5
HSK A100	511.100.02.040.120	40	80	120	3.1
	511.100.02.008.080	8	28	80	2.2
	511.100.02.010.080	10	35	80	2.2
	511.100.02.012.080	12	42	80	2.3
	511.100.02.016.100	16	48	100	2.8
	511.100.02.020.100	20	52	100	3
	511.100.02.025.100	25	65	100	3.6
511.100.02.032.100	32	72	100	3.8	
511.100.02.040.120	40	80	120	4.7	
511.100.02.050.130	50	100	130	6.2	

Accessories



Coolant Tube



Coolant Tube Spanner



Grub Screw



Stopper Screw

Note: Special Designs and Sizes are Available on Request

Coolant Tube and Coolant Tube Spanner order Separately

DIN 69893-1 HSK Form-B,C,D,E,F, Tool Holders are Available on Request



DIN-69893 HSK-A

Side Lock Holder - Extra Length

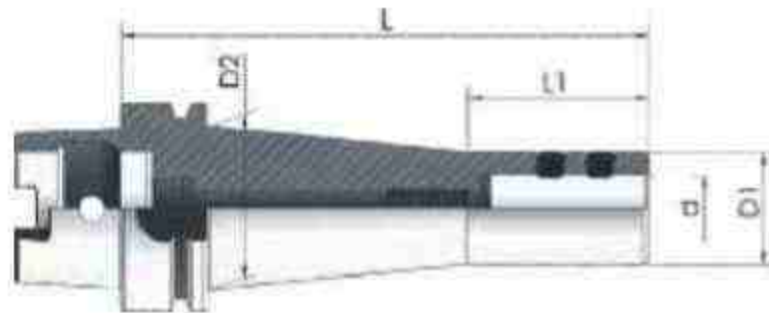

Taper	Ordering Code	d	D1	D2	L	L1	Wt. in Kgs.
HSK A63	511.063.02.008.160	8	24	34	160	40	1.2
	511.063.02.010.160	10	27	38	160	45	1.3
	511.063.02.012.160	12	32	42	160	50	1.4
	511.063.02.016.160	16	36	44	160	55	1.7
	511.063.02.020.160	20	45	50	160	55	1.7
	511.063.02.025.160	25	65	65	160	-	3.3
HSK A100	511.100.02.008.160	8	24	34	160	40	2.5
	511.100.02.010.160	10	27	38	160	45	2.7
	511.100.02.012.160	12	32	42	160	50	2.9
	511.100.02.016.160	16	36	44	160	55	2.8
	511.100.02.020.160	20	45	50	160	55	3
	511.100.02.025.160	25	56	65	160	60	5
	511.100.02.032.160	32	72	72	160	-	5.6
	511.100.02.040.160	40	80	80	160	-	6.3

Note: Special Designs and Sizes are Available on Request
 Coolant Tube and Coolant Tube Spanner order Separately
 DIN 69893-1 HSK Form-B,C,D,E,F, Tool Holders are Available on Request

Accessories



Coolant Tube Coolant Tube Spanner Grub Screw Stopper Screw



HSK-A

DIN-69893 HSK-A

Face Mill Holder - Through Coolant

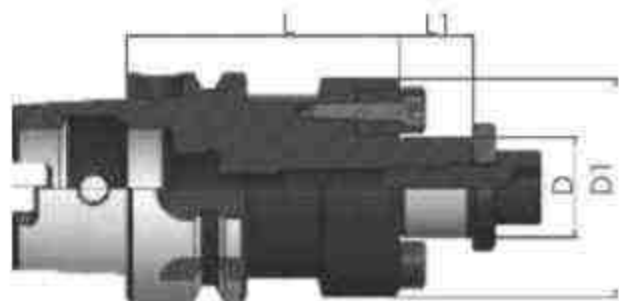

Standard Length

Taper	Ordering Code	D	D1	L	L1	Wt. in Kgs.
HSK A50	511.050.03.016.060.TC	16	34	60	14	0.6
	511.050.03.022.070.TC	22	48	70	16	1
	511.050.03.027.070.TC	27	60	70	18	1.2
HSK A63	511.063.03.016.060.TC	16	34	60	14	0.9
	511.063.03.022.060.TC	22	48	60	16	1.2
	511.063.03.027.070.TC	27	60	70	18	1.5
	511.063.03.032.070.TC	32	68	70	20	1.7
HSK A100	511.063.03.040.070.TC	40	80	70	23	2
	511.100.03.016.070.TC	16	34	70	14	2.2
	511.100.03.022.070.TC	22	48	70	16	2.6
	511.100.03.027.070.TC	27	60	70	18	2.9
	511.100.03.032.070.TC	32	70	70	20	3.3
	511.100.03.040.070.TC	40	80	70	23	3.9

Extra Length

HSK A63	511.063.03.016.100.TC	16	34	100	14	1.3
	511.063.03.022.100.TC	22	48	100	16	1.8
	511.063.03.027.100.TC	27	60	100	18	2.2
	511.063.03.032.100.TC	32	68	100	20	2.6
	511.063.03.040.100.TC	40	80	100	23	3.3
HSK A100	511.100.03.016.100.TC	16	34	100	14	2.9
	511.100.03.022.100.TC	22	48	100	16	3.3
	511.100.03.027.100.TC	27	60	100	18	3.6
	511.100.03.032.100.TC	32	70	100	20	4.2
	511.100.03.040.100.TC	40	80	100	23	6.6

Note: Special Designs, Inch size Face Mill Holder are available on request.
DIN 69893-1 HSK Form-B, C, D, E, F, Tool Holders are Available on Request.



DIN-69893 HSK-A Face Mill Arbor - Flange Type

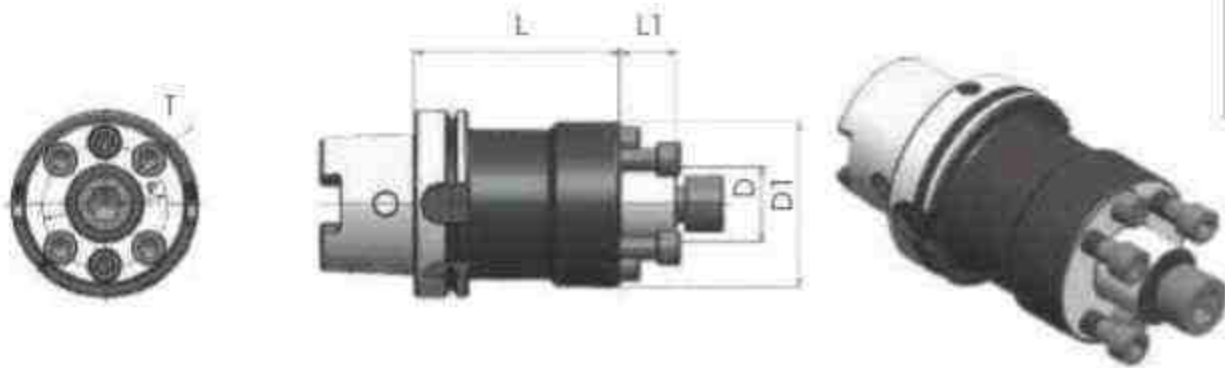

Taper	Ordering Code	D	D1	L	L1	P	T	WL in Kgs.
HSK A100	511.100.03.040.070.H	40	88	70	30	68.7	M12	3.9
	511.100.03.060.070.H	60	128	70	40	101.6	M16	6.2

DIN-69893 HSK-A Test Bar

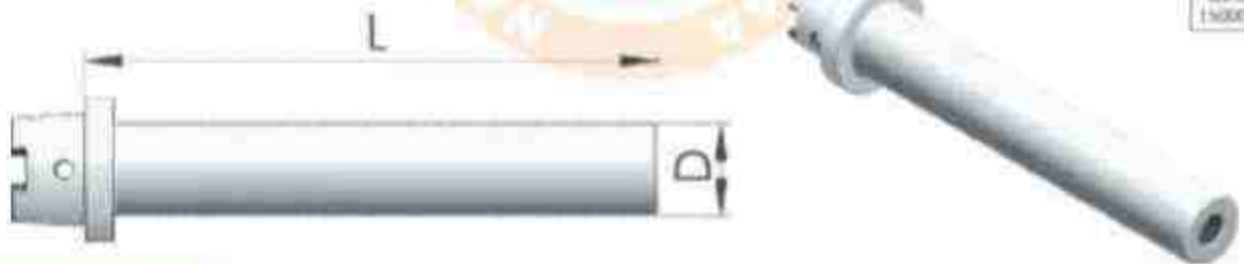

Taper	Ordering Code	D	L	WL in Kgs.
HSK 50	TEST BAR HSK 50	32	348	1.4
HSK 63	TEST BAR HSK 63	40	346	3.2
HSK 100	TEST BAR HSK 100	50	300	4.6

Note

Special Designs and Sizes are available on Request.
Coolant Tube and Coolant Tube Spanner order Separately.
DIN 69893-1 HSK Form-B, C, D, E, F, Tool Holders are Available on Request

Accessories



Coolant Tube Coolant Tube Spanner Driving Key Allen Screw Washer Allen Screw



HSK-A

DIN-69893 HSK-A Shrink Fit Holder

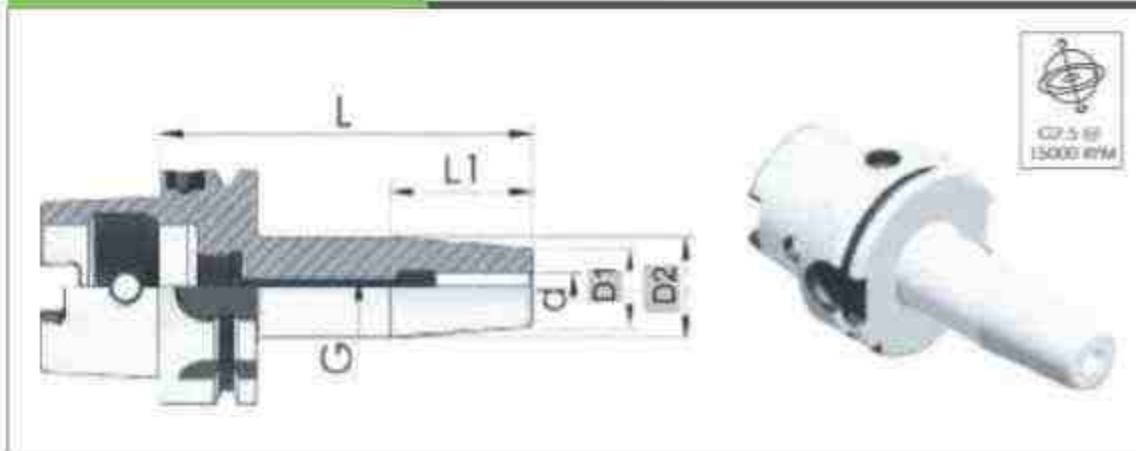

Accessories



Coolant Tube Spanner

Taper	Ordering Code	d	D1	D2	L	L1	G	Wt in Kgs
HSK A50	511.050.05.006.080	6	21	27	80	36	M5	0.6
	511.050.05.008.080	8	21	27	80	36	M6	0.6
	511.050.05.010.085	10	24	32	85	42	M8	0.64
	511.050.05.012.090	12	24	32	90	47	M10	0.66
	511.050.05.014.090	14	27	34	90	47	M10	0.68
	511.050.05.016.095	16	27	34	95	50	M12	0.7
	511.050.05.020.100	20	33	42	100	52	M16	0.9
HSK A63	511.063.05.006.080	6	21	27	80	36	M5	0.83
	511.063.05.008.080	8	21	27	80	36	M6	0.83
	511.063.05.010.085	10	24	32	85	42	M8	0.92
	511.063.05.012.090	12	24	32	90	47	M10	0.92
	511.063.05.014.090	14	27	34	90	47	M10	0.93
	511.063.05.016.095	16	27	34	95	50	M12	0.96
	511.063.05.020.100	20	33	42	100	52	M16	1.18
	511.063.05.025.115	25	44	53	115	58	M16	1.75
HSK A100	511.100.05.006.085	6	21	27	85	36	M5	2.2
	511.100.05.008.085	8	21	27	85	36	M6	2.2
	511.100.05.010.090	10	24	32	90	42	M8	2.3
	511.100.05.012.095	12	24	32	95	47	M10	2.3
	511.100.05.014.095	14	27	34	95	47	M10	2.3
	511.100.05.016.100	16	27	34	100	50	M12	2.4
	511.100.05.020.105	20	33	42	105	52	M16	2.5
	511.100.05.025.115	25	44	53	115	58	M16	3
	511.100.05.032.120	32	44	53	120	58	M16	3

Notes: Special Designs and Sizes are Available on Request. Coolant Tube and Coolant Tube Spanner order Separately
DIN 69893-1 HSK Form-B, C, D, E, F, Tool Holders are Available on Request



BT MAS 403 (JIS B 6339) Tool Holders



Collet Chuck Holder - Standard Length	19
Collet Chuck Holder - Extra Length	20
Side Lock Holder - Standard Length	21
Side Lock Holder - Extra Length	22
Face Mill Holder - Standard & Extra Length	23
Face Mill Arbor - Flange Type Reduction Adapter	24
Morse Taper Adapter - Tanged End Test Bar	25
Mini nut Collet chuck holder Drill Chuck Holder	26
Shrink Fit Holder	27

Overview of BT

BT (MAS 403) tool holders are a Japanese development with JIS standard JIS B 6339. BT Shank has 7:24 taper ratio. BT connection with spindle made by pull stud, pulled by machine drawbar and comes to taper contact. BT Tooling is symmetrical about the spindle axis which gives great stability and balance at high speeds.



BT MAS 403 (JIS B 6339)

Collet Chuck Holder DIN 6499 - Standard Length

Form-AD



Taper	Ordering Code	Suitable Collet	Clamping Range	L	D	Spanner	Wt. in Kgs.
30	512.030.01.016.070	ER 16	1-10	70	28	611.07.16	0.5
	512.030.01.020.070	ER 20	1-13	70	34	611.07.20	0.6
	512.030.01.025.070	ER 25	1-16	70	42	611.07.25	0.7
	512.030.01.032.070	ER 32	2-20	70	50	611.07.32	0.7
40	512.040.01.011.070	ER 11	1-7	70	19	611.07.11	1
	512.040.01.011.100	ER 11	1-7	100	19	611.07.11	1.2
	512.040.01.016.070	ER 16	1-10	70	28	611.07.16	1.1
	512.040.01.016.100	ER 16	1-10	100	28	611.07.16	1.3
	512.040.01.020.070	ER 20	1-13	70	34	611.07.20	1.1
	512.040.01.020.100	ER 20	1-13	100	34	611.07.20	1.4
	512.040.01.025.070	ER 25	1-16	70	42	611.07.25	1.2
	512.040.01.025.100	ER 25	1-16	100	42	611.07.25	1.4
	512.040.01.032.070	ER 32	2-20	70	50	611.07.32	1.2
	512.040.01.032.100	ER 32	3-20	100	50	611.07.32	1.5
	512.040.01.040.070	ER 40	3-26	70	63	611.07.40	1.3
	512.040.01.040.100	ER 40	4-26	100	63	611.07.40	1.8
512.040.01.050.100	ER 50	10-34	100	78	611.07.50	2.1	
50	512.050.01.016.080	ER 16	1-10	80	28	611.07.16	3.7
	512.050.01.016.100	ER 16	1-10	100	28	611.07.16	4.0
	512.050.01.020.080	ER 20	1-13	80	34	611.07.20	3.7
	512.050.01.020.100	ER 20	1-13	100	34	611.07.20	4.0
	512.050.01.025.080	ER 25	1-16	80	42	611.07.25	3.8
	512.050.01.025.100	ER 25	1-16	100	42	611.07.25	4.1
	512.050.01.032.080	ER 32	2-20	80	50	611.07.32	3.7
	512.050.01.032.100	ER 32	2-20	100	50	611.07.32	4.2
	512.050.01.040.080	ER 40	3-26	80	63	611.07.40	3.8
	512.050.01.040.100	ER 40	3-26	100	63	611.07.40	4.3
	512.050.01.050.080	ER 50	10-34	80	78	611.07.50	3.9
	512.050.01.050.100	ER 50	10-34	100	78	611.07.50	4.4

Accessories



Flange through coolant, Special Designs, Sizes and Mini nut ER8, ER11, ER16, ER20, ER25 collect chuck are available on Request. Spanner order Separately.

BT MAS 403 (JIS B 6339)

Collet Chuck Holder DIN 6499 - Extra Length

Form - AD



Taper	Ordering Code	Suitable Collet	Clamping Range	L	D	Spanner	Wt. in Kgs.
40	512.040.01.016.120	ER16	1-10	120	28	611.07.16	1.2
	512.040.01.016.135	ER16	1-10	135	28	611.07.16	1.2
	512.040.01.016.160	ER16	1-10	160	28	611.07.16	1.3
	512.040.01.020.120	ER20	1-13	120	34	611.07.20	1.2
	512.040.01.020.135	ER20	1-13	135	34	611.07.20	1.2
	512.040.01.020.160	ER20	1-13	160	34	611.07.20	1.4
	512.040.01.025.120	ER25	1-16	120	42	611.07.25	1.4
	512.040.01.025.135	ER25	1-16	135	42	611.07.25	1.4
	512.040.01.025.160	ER25	1-16	160	42	611.07.25	1.7
	512.040.01.032.120	ER32	3-20	120	50	611.07.32	1.5
	512.040.01.032.135	ER32	3-20	135	50	611.07.32	1.5
	512.040.01.032.160	ER32	3-20	160	50	611.07.32	1.5
	512.040.01.040.120	ER40	4-26	120	63	611.07.40	1.8
	512.040.01.040.135	ER40	4-26	135	63	611.07.40	1.8
	512.040.01.040.160	ER40	4-26	160	63	611.07.40	1.8
	50	512.050.01.016.135	ER16	1-10	135	28	611.07.16
512.050.01.016.160		ER16	1-10	160	28	611.07.16	3.8
512.050.01.020.135		ER20	1-13	135	34	611.07.20	4.2
512.050.01.020.160		ER20	1-13	150	34	611.07.20	4
512.050.01.025.135		ER25	1-16	135	42	611.07.25	4.1
512.050.01.025.160		ER25	1-16	160	42	611.07.25	4.4
512.050.01.032.135		ER32	3-20	135	50	611.07.32	4.3
512.050.01.032.160		ER32	3-20	160	50	611.07.32	4.5
512.050.01.040.135		ER40	4-26	135	63	611.07.40	4.6
512.050.01.040.160		ER40	4-26	160	63	611.07.40	4.8
Accessories	512.050.01.050.135	ER50	10-26	135	78	611.07.50	4.9
	512.050.01.050.160	ER50	10-26	160	78	611.07.50	5.2



Note :

Flange through coolant, Special Designs, Sizes and Mini nut ER8, ER11, ER16, ER20, ER25 collect chuck are available on Request. Spanner order Separately.



BT MAS 403 (JIS B 6339)

Side Lock Holder - Standard Length

Form - AD



Taper	Ordering Code	d	D	L	WL in Kgs.	Grub Screw
30	512.030.02.008.065	8	24	65	0.5	M8
	512.030.02.010.065	10	30	65	0.6	M10
	512.030.02.012.065	12	35	65	0.6	M10
	512.030.02.016.065	16	40	65	0.7	M10
	512.030.02.020.090	20	50	90	1.2	M10
	512.030.02.025.090	25	50	90	1.1	M10
40	512.040.02.008.065	8	24	65	1	M8
	512.040.02.010.065	10	30	65	1.2	M10
	512.040.02.012.065	12	35	65	1.2	M10
	512.040.02.016.065	16	40	65	1.3	M10
	512.040.02.020.090	20	50	90	1.4	M10
	512.040.02.025.090	25	50	90	2.4	M10
	512.040.02.032.090	32	60	90	2.6	M10
	512.040.02.040.090	40	63	90	3.1	M12
50	512.050.02.008.070	8	28	70	3.7	M8
	512.050.02.010.070	10	35	70	3.8	M10
	512.050.02.012.080	12	42	80	4	M10
	512.050.02.016.080	16	48	80	4	M12
	512.050.02.020.080	20	52	80	4.1	M16
	512.050.02.025.105	25	65	105	4.9	M16
	512.050.02.032.105	32	72	105	5.1	M16
	512.050.02.040.105	40	80	105	5.2	M16
512.050.02.050.105	50	100	105	6.7	M16	

Accessories



Note: Special Designs and Sizes are Available on Request

BT MAS 403 (JIS B 6339)

Side Lock Holder - Extra Length

Form - AD

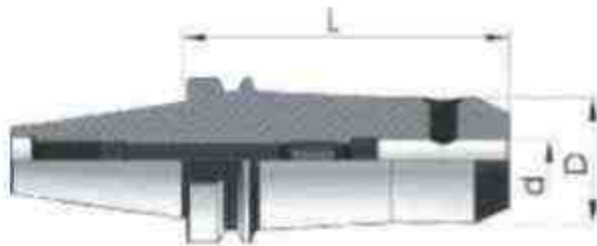

Taper	Ordering Code	d	D	L	Wt. in Kgs.	Grub Screw
40	512.040.02.008.120	8	24	120	1.4	M8
	512.040.02.010.120	10	27	120	1.7	M10
	512.040.02.012.120	12	32	120	2	M10
	512.040.02.016.120	16	38	120	2.1	M10
	512.040.02.020.120	20	45	120	2.3	M10
	512.040.02.020.160	20	45	160	2.6	M10
	512.040.02.025.120	25	45	120	3	M10
	512.040.02.025.160	25	45	160	3.2	M10
	512.040.02.032.120	32	54	120	3.15	M12
	512.040.02.032.160	32	54	160	3.45	M12
	512.040.02.040.120	40	60	120	3.5	M8
	512.040.02.040.160	40	60	160	3.8	M10
50	512.050.02.008.150	8	24	150	4.2	M10
	512.050.02.010.150	10	27	150	4.5	M10
	512.050.02.012.150	12	32	150	4.9	M10
	512.050.02.016.150	16	30	150	5.1	M12
	512.050.02.020.120	20	36	120	5.1	M16
	512.050.02.020.160	20	36	160	5.5	M16
	512.050.02.025.120	25	45	120	6.1	M16
	512.050.02.025.160	25	45	160	6.5	M16
	512.050.02.032.120	32	45	120	6.8	M16
	512.050.02.032.160	32	45	160	7	M16
	512.050.02.040.120	40	65	120	7.1	M16
	512.050.02.040.160	40	65	160	7.4	M16

Accessories



Pull Stud

Grub Screw

Stopper Screw

Note: Special Designs and Sizes are Available on Request



BT MAS 403 (JIS B 6339)

Face Mill Holder - Through Coolant

Form - AD



Taper	Ordering Code	D	L	L1	D1	Cutter Dia	Wt. in Kgs.
30	512.030.03.016.050.TC	16	50	14	34	40	0.8
	512.030.03.022.050.TC	22	50	16	48	50 & 63	0.8
	512.030.03.027.050.TC	27	50	18	60	80	1.0
40	512.040.03.016.060.TC	16	60	14	34	40	1.2
	512.040.03.016.120.TC	16	120	14	34	40	1.7
	512.040.03.022.060.TC	22	60	16	48	50 & 63	1.5
	512.040.03.022.090.TC	22	90	16	48	50 & 63	1.9
	512.040.03.022.120.TC	22	120	16	48	50 & 63	2.3
	512.040.03.022.160.TC	22	160	16	48	50 & 63	2.6
	512.040.03.027.045.TC	27	45	18	60	80	1.4
	512.040.03.027.090.TC	27	90	18	60	80	2.4
	512.040.03.027.105.TC	27	105	18	60	80	2.7
	512.040.03.027.120.TC	27	120	18	60	80	2.9
	512.040.03.032.060.TC	32	60	20	70	100	2
	512.040.03.032.090.TC	32	90	20	80	125	2.7
50	512.040.03.040.060.TC	40	60	23	80	125	2.5
	512.040.03.040.075.TC	40	75	23	48	50 & 63	2.8
	512.050.03.022.075.TC	22	75	16	48	50 & 63	4.2
	512.050.03.022.120.TC	22	120	16	48	50 & 63	4.9
	512.050.03.022.160.TC	22	160	16	48	50 & 63	5.3
	512.050.03.027.060.TC	27	60	18	60	80	4.2
	512.050.03.027.100.TC	27	100	18	60	80	5.2
	512.050.03.027.120.TC	27	120	18	60	80	5.5
	512.050.03.027.160.TC	27	160	18	60	80	5.8
	512.050.03.032.060.TC	32	60	20	70	100	4.4
	512.050.03.032.090.TC	32	90	20	70	100	5.3
	512.050.03.032.160.TC	32	160	20	70	100	5.9
50	512.050.03.040.060.TC	40	60	23	80	125	4.8
	512.050.03.040.100.TC	40	100	23	80	125	6.6
	512.050.03.040.160.TC	40	160	23	80	125	7.1

Accessories



Pull Stud

Driving Key

Allen Screw

Washer

Allen Screw

Special Designs, Inch size Facemill Holder and Flange through coolant are available on request.



BT MAS 403 (JIS B 6339)

Face Mill Holder - Flange Type

Form - AD



Taper	Ordering Code	D	D1	L	L1	T	P	Cutter Dia	Wt. in Kgs.
40	512.040.03.040.060.H	40	88	60	30	M 12	66.7	160	2.6
50	512.050.03.040.075.H	40	88	75	30	M 12	66.7	160	5.7
	512.050.03.060.075.H	60	128	75	40	M 16	101.6	200-500	7.6

BT MAS 403 (JIS B 6339)

Reduction Adapter

Form - AD



Taper	Ordering Code	T	L	Wt. in Kgs.
40	BT40 RA BT30	BT30	60	1.5
	BT50 RA BT30	BT30	50	3.9
50	BT50 RA BT40	BT40	50	2.7
	BT50 RA HSKA 63	HSKA 63	40	3.5
	BT50 RA HSKA 100	HSKA100	100	5.8

Accessories



Pull Stud

Driving Key

Allen Screw

Allen Screw

Note: Spanner Order Separately. Special Designs and Sizes are Available on Request



BT

BT MAS 403 (JIS B 6339)

Morse Taper Adapter - Tanged End

Form - AD

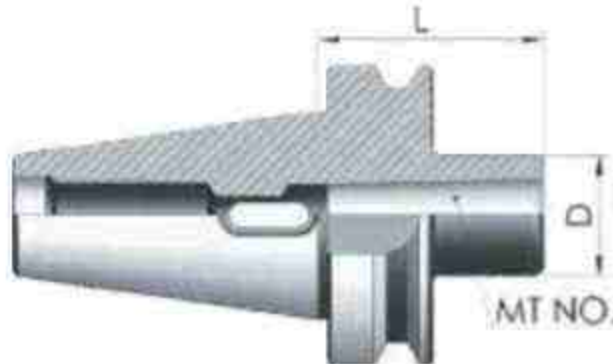

Taper	Ordering Code	MT No.	L	D	Wt. in Kgs.
30	512.030.04.001.050	1	50	25	0.4
	512.030.04.002.062	2	62	32	0.5
	512.030.04.003.080	3	80	40	0.7
40	512.040.04.001.045	1	45	25	1
	512.040.04.002.060	2	60	32	1
	512.040.04.003.075	3	75	40	1.1
	512.040.04.004.095	4	95	50	1.3
50	512.050.04.001.045	1	45	25	3.5
	512.050.04.002.045	2	45	32	3.4
	512.050.04.003.045	3	45	40	3.4
	512.050.04.004.075	4	75	50	3.5
	512.050.04.005.105	5	105	70	4

BT MAS 403 (JIS B 6339)

Test Bar

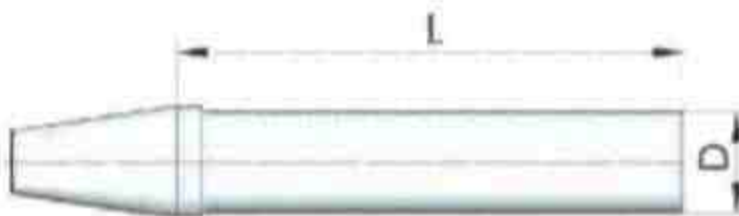

Taper	Ordering Code	D	L	Wt. in Kgs.
30	TEST BAR BT 30	30	250	1.2
40	TEST BAR BT 40	40	300	2.7
50	TEST BAR BT 50	50	350	6.2

Note: Special Designs and Sizes are Available on Request.



BT MAS 403 (JIS B 6339)

Collet Chuck Holder - DIN 6499 Mini Nut

Form - AD



Taper	Ordering Code	Suitable Collet	Clamping Range	L	D	Spanner	Wt. in Kgs.
40	512.040.01.016.070.M	ER16	1-10	70	22	611.07.16 M	1
	512.040.01.016.150.M	ER16	1-10	150	22	611.07.16 M	1.2
	512.040.01.020.070.M	ER20	1-13	70	28	611.07.20 M	1
	512.040.01.020.150.M	ER20	1-13	150	28	611.07.20 M	1.3
	512.040.01.025.070.M	ER25	1-16	70	35	611.07.25 M	1.1
	512.040.01.025.150.M	ER25	1-16	150	35	611.07.25 M	1.6
50	512.050.01.016.100.M	ER16	1-10	100	22	611.07.16 M	3.7
	512.050.01.016.150.M	ER16	1-10	150	22	611.07.16 M	3.6
	512.050.01.020.100.M	ER20	1-13	100	28	611.07.20 M	3.8
	512.050.01.020.150.M	ER20	1-13	150	28	611.07.20 M	3.9
	512.050.01.025.100.M	ER25	1-16	100	35	611.07.25 M	3.9
	512.050.01.025.150.M	ER25	1-16	150	35	611.07.25 M	4

BT MAS 403 (JIS B 6339)

Drill Chuck Holder

Note: Spanner Order Separately
Special Designs and Sizes are Available on Request

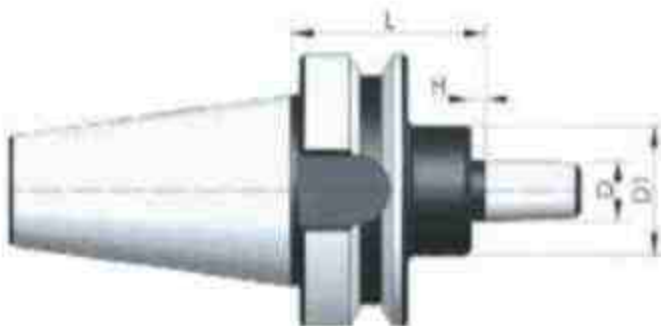

Taper	Ordering Code	Keyless Chuck Clamping Range	Taper No	L	D	D1	H	Wt. in Kgs.
40	512.040.08.006.045	0.8-13	JTA6	45	17.170	30	4	1.1
	512.040.08.016.045	0.8-13	B16	45	15.733	30	4	1.1
50	512.050.08.006.045	0.8-13	JTA6	45	17.170	30	4	3.7
	512.050.08.016.045	0.8-13	B16	45	15.733	30	4	3.7



BT MAS 403 (JIS B 6339)

Shrink Fit Holder

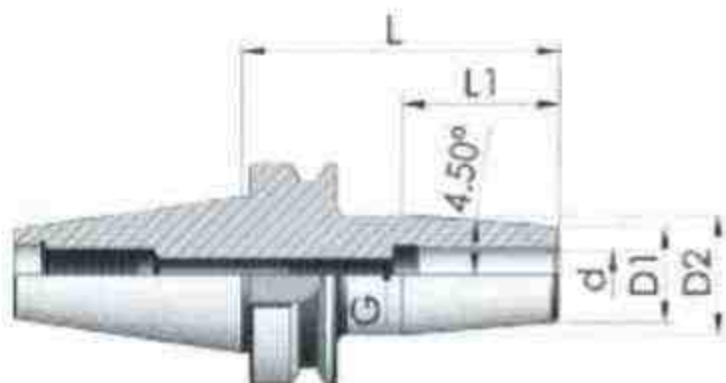

Taper	Ordering Code	d	D1	D2	L	L1	G	Wt in Kgs
40	512.040.05.06.090	6	21	27	90	36	M5	1.2
	512.040.05.08.090	8	21	27	90	36	M6	1.2
	512.040.05.10.090	10	24	32	90	42	M8	1.3
	512.040.05.12.090	12	24	32	90	47	M10	1.5
	512.040.05.14.090	14	27	34	90	47	M10	1.2
	512.040.05.16.090	16	27	34	90	50	M12	1.2
	512.040.05.20.090	20	33	42	90	52	M16	1.3
	512.040.05.25.100	25	44	53	100	58	M16	1.8
50	512.050.05.06.100	6	21	27	100	36	M5	3.8
	512.050.05.08.100	8	21	27	100	36	M6	3.8
	512.050.05.10.100	10	24	32	100	42	M8	3.9
	512.050.05.12.100	12	24	32	100	47	M10	3.9
	512.050.05.14.100	14	27	34	100	47	M10	3.9
	512.050.05.16.100	16	27	34	100	50	M12	3.8
	512.050.05.20.100	20	33	42	100	52	M16	3.9
	512.050.05.25.100	25	44	53	100	58	M16	4.2
	512.050.05.32.100	32	44	53	100	58	M16	4.0

Note : Special Designs and Sizes or Available on Request .

Accessories



Pull Stud



Rough & Finish Boring Bars



Basic Holder

29

Extension

38

Modular Heavy Duty Finish Boring Bars

Modular Heavy Duty Rough Boring Bars

Modular Rough Boring Bars

27

Modular Finish Boring Bars



BASIC HOLDER - HSK (DIN 69893)



Taper	Ordering Code	D	L	WT. in Kgs.
63	511H.063.00.050.090	50	90	1.2
63	511H.063.00.063.105	63	105	2.1
63	511H.063.00.100.130	100	130	5.6
100	511H.100.00.050.100	50	100	3.0
100	511H.100.00.063.115	63	115	3.7
100	511H.100.00.100.135	100	135	6.5

BASIC HOLDER - BT MAS 403 (JIS 6335)



Taper	Ordering Code	D	L	WT. in Kgs.
40	512H.040.00.050.040	50	040	1.1
40	512H.040.00.063.060	63	060	1.4
50	512H.050.00.050.038	50	038	3.6
50	512H.050.00.063.038	63	038	3.3
50	512H.050.00.100.100	100	100	5.6

BASIC HOLDER - SK (DIN 69871)



Taper	Ordering Code	D	L	WT. in Kgs.
40	513H.040.00.050.040	50	040	1.1
40	513H.040.00.063.075	63	075	1.6
50	513H.050.00.050.030	50	030	2.8
50	513H.050.00.063.030	63	030	2.5
50	513H.050.00.100.095	100	095	5.3

Note : Other spindle taper are available on request



EXTENSION



Ordering Code	D	L	WT. in Kgs.
518H.050.13.050.075	50	75	1.1
518H.050.13.050.100	50	100	1.4
518H.063.13.063.075	63	75	1.8
518H.063.13.063.100	63	100	2.3
518H.100.13.100.100	100	100	5.5

MODULAR ADJUSTABLE HEAVY DUTY FINISH BORING BAR



Boring Range ID	OD	Ordering Code	L	L1	WT. in Kgs.
150 - 175	40 - 65	518.080.16.150.135	135	65	3.5
175 - 200	65 - 90	518.080.16.175.135	135	65	4.5
200 - 225	90 - 115	518.080.16.200.135	135	65	4.6
225 - 250	75 - 100	518.080.16.225.120	120	70	5.4
250 - 275	100 - 125	518.080.16.250.120	120	70	5.5
275 - 300	125 - 150	518.080.16.275.120	120	70	5.6
300 - 325	150 - 175	518.080.16.300.120	120	70	5.9
325 - 350	175 - 200	518.080.16.325.120	120	70	6.0

CARTRIDGES : NT-FB-532.515 TC11 INSERT : TCMT110204
Order Cartridge separately

MODULAR ADJUSTABLE HEAVY DUTY ROUGH BORING BAR

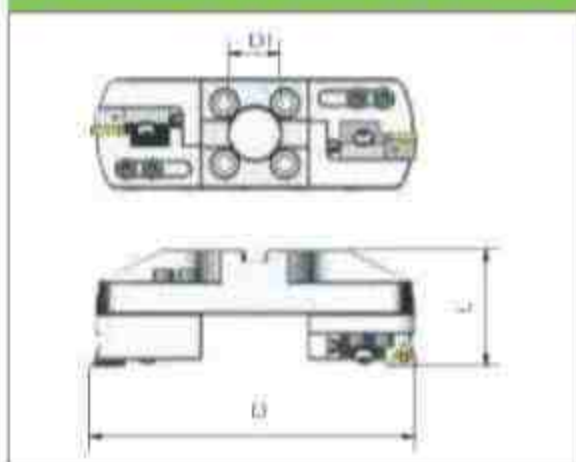

Boring Range	Ordering Code	D1	L	Cartridge Part No.	WT. in Kgs.
250 - 300	529.040.15.250.090	40	90	STGCL 16CA 16	4.2
275 - 325	529.040.15.275.090	40	90	STGCL 16CA 16	4.2
300 - 350	529.040.15.300.090	40	90	STGCL 16CA 16	4.5
325 - 375	529.040.15.325.090	40	90	STGCL 16CA 16	4.5
350 - 400	529.040.15.350.090	40	90	STGCL 16CA 16	4.9
375 - 425	529.040.15.375.090	40	90	STGCL 16CA 16	4.9

INSERT : TCMT16 T3 08
Order Cartridge separately

*Specifications are subject to change without prior notice due to continuous development.



BORING BARS

MODULAR ROUGH BORING BAR

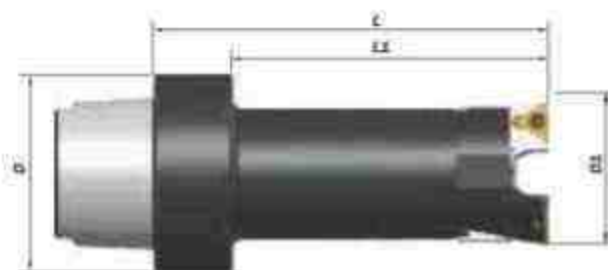

FIG.1



FIG.2

Ordering Code	Boring range D1	D	L	L1	Slide No.	Insert Type	Fig. No.	WT. in Kgs
518H.050.15.025.090	25 - 32	50	90	70	611.28.025.CC 06	CCMT 06 02 08	1	0.7
518H.050.15.030.110	30 - 38	50	110	90	611.28.030.CC 06	CCMT 06 02 08	1	0.7
518H.050.15.037.110	37 - 47	50	110	90	611.28.037.TC 11	TCMT 11 02 08	1	0.9
518H.050.15.046.110	46 - 56	50	110	90	611.28.046.TC 16	TCMT 16 T3 08	1	1.2
518H.050.15.055.085	55 - 70	50	85	-	611.28.055.TC 16	TCMT 16 T3 08	1	1.1
518H.063.15.069.090	69 - 85	63	90	-	611.28.069.TC 16	TCMT 16 T3 08	2	1.9
	83 - 100	63	90	-	611.28.083.TC 16	TCMT 16 T3 08	2	2.0
518H.100.15.099.125	99 - 126	100	125	105	611.28.099.TC 16	TCMT 16 T3 08	2	4.2
	123 - 150	100	125	-	611.28.123.TC 16	TCMT 16 T3 08	2	1.2
	148 - 190	100	125	-	611.28.148.TC 16	TCMT 16 T3 08	2	6.6
518H.100.15.148.125	188 - 230	100	125	-	611.28.188.TC 16	TCMT 16 T3 08	2	7.1
	228 - 270	100	125	-	611.28.228.TC 16	TCMT 16 T3 08	2	7.7

MODULAR FINISH BORING BAR

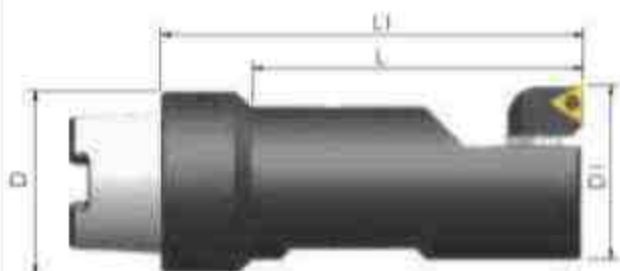

FINE BORING UNIT



Finish Boring Bars will be supplied from ø25 mm with ±1 mm adjustment in dia

Ordering Example : ø52 mm, Working Length - 100mm



YOUJI VTL ATC Mode BT/ST Tool Holder

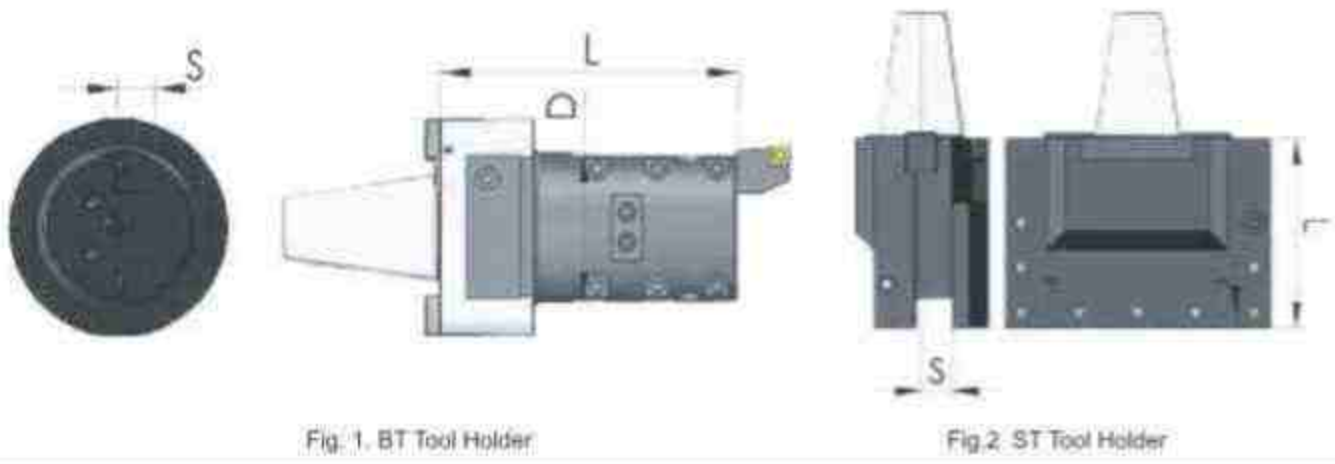

Fig. 1. BT Tool Holder

Fig. 2. ST Tool Holder

Ordering Code	Fig.	L	S	D	Wt. in. Kgs.
527.01.21.025.200	Fig.1	200	25	100	17
527.01.22.025.300	Fig.1	300	25	110	25
527.01.23.032.160	Fig.2	160	32	-	26
527.01.24.040.160	Fig.2	160	40	-	25.5

YOUJI VTL ATC Mode BB Tool Holder / ATC + C Model MST Tool Holders



Fig. 1. BB Tool Holder

Fig. 2. MST Tool Holder

Ordering Code	Fig.	L	S	D	Wt. in. Kgs.
527.01.25.025.200	Fig.1	200	25	100	17
527.01.26.025.300	Fig.1	300	25	110	25
527.02.27.032.160	Fig.2	160	32	-	18
527.02.28.040.160	Fig.2	160	40	-	19.5

Note Other Sq. Tool Sizes are available on request



YOUJI VTL ATC+C Mod MBB Tool Holder

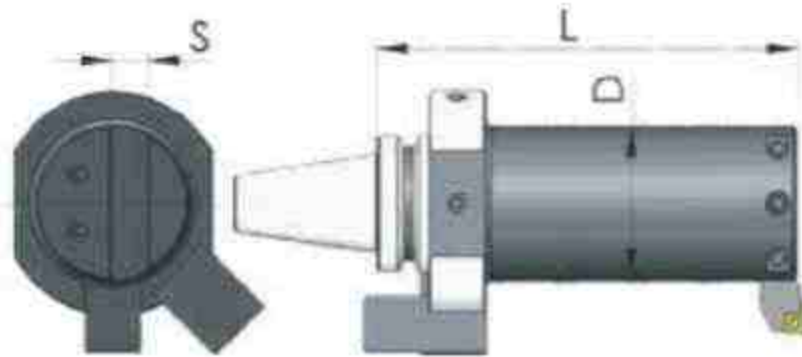

Ordering Code	L	S	D	Wt. in. Kgs.
527.02.29.100.200	200	25	100	18
527.02.30.110.300	300	25	110	28.5

YOUJI VTL ATC+C Mod MBT Tool Holder



Ordering Code	L	S	D	Wt. in. Kgs.
527.02.31.100.200	200	25	100	18.5
527.02.32.110.300	300	25	110	26

Note: Other Sq. Tool Sizes are available on request

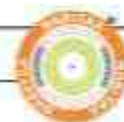

Trevisan DS300 /DS450/DS600

Collet Chuck Holders

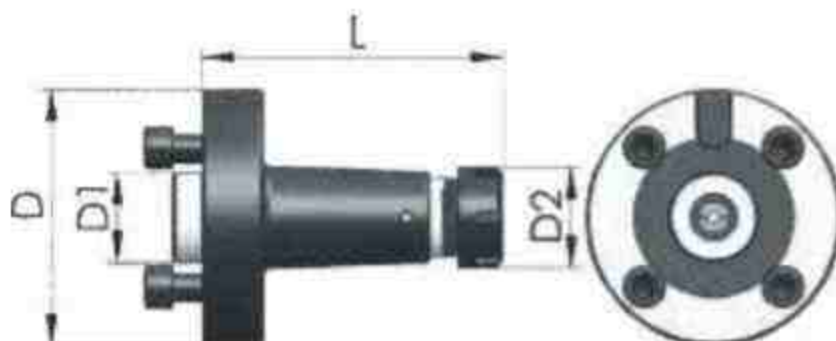

Ordering Code	D	D1	D2	L	Wt. in. Kgs.
528.045.01.025.120	128	45	42	120	4.0
528.045.01.032.120	128	45	50	120	4.1
528.045.01.040.120	128	45	63	120	4.4
528.045.01.050.120	128	45	78	120	4.7
528.045.01.025.175	128	45	42	175	4.5
528.045.01.032.175	128	45	50	175	5.0
528.045.01.040.175	128	45	63	175	5.5
528.045.01.050.175	128	45	78	175	5.8

Trevisan DS300 /DS450/DS600

Turning Tool Holders

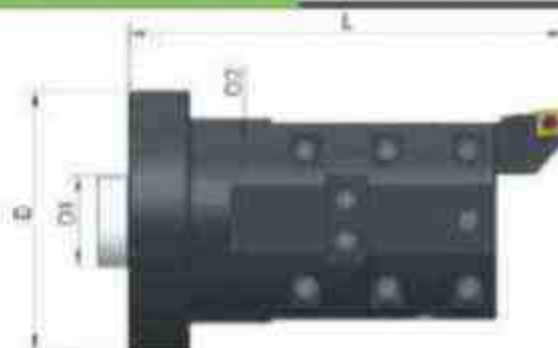

Ordering Code	D	D1	D2	L	Sq. Tool	Wt. in. Kgs.
528.045.37.100.225	128	45	100	225	25x25	13.2
528.045.37.100.250	128	45	100	250	25x25	14.8
528.045.37.100.315	128	45	100	315	25x25	18.5

Note: Other Sq. Tool Sizes are available on request. Holders for DS900/DS1200/DS1500 are available on request.



Trevisan DS300 /DS450/DS600 Boring Bar Holders

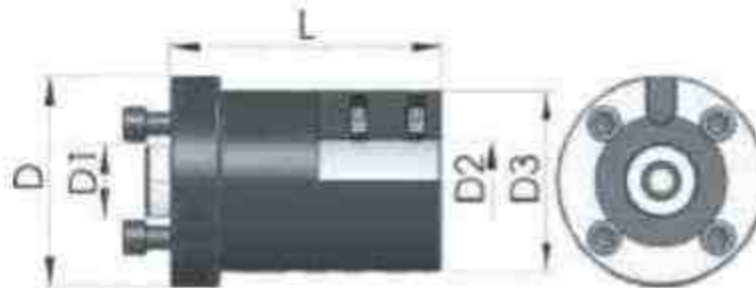

Ordering Code	D	D1	D2	D3	L	wt. in. Kgs.
528.045.02.020.090	128	45	20	70	90	4.5
528.045.02.020.120	128	45	20	70	120	5.7
528.045.02.025.120	128	45	25	70	120	5.52
528.045.02.025.150	128	45	25	70	150	6.4
528.045.02.032.120	128	45	32	70	120	5.3
528.045.02.032.150	128	45	32	70	150	6.13
528.045.02.040.150	128	45	40	90	150	7.8
528.045.02.050.150	128	45	50	110	150	10

Trevisan DS300 /DS450/DS600 Face Mill Holders



Ordering Code	D	D1	D2	D3	L	L1	wt. in. Kgs.
528.045.03.022.060	128	45	22	48	60	16	3.7
528.045.03.027.060	128	45	27	60	60	18	3.9
528.045.03.032.060	128	45	32	70	60	20	4.1
528.045.03.040.060	128	45	40	80	60	25	4.1
528.045.03.022.105	128	45	22	48	105	16	4.5
528.045.03.027.105	128	45	27	60	105	18	4.9
528.045.03.032.105	128	45	32	70	105	20	5.4
528.045.03.040.105	128	45	40	80	105	25	6

Note: Other Sq.Tool Sizes are available on request. Holders for DS900/DS1200/DS1500 are available on request.



NARITAA



Runout Accuracy $\leq 3\mu\text{m}$ at
2.5 D or max. 50 mm



Extremely fast tool changing
with a turn of 'T' wrench



All Hydraulic
Holders
are Gel filled



HydNairTM

HYDRAULIC CLAMPING TOOL HOLDERS

BT MAS 403 (JIS B 6339) Hydraulic Clamping Tool Holders - HydNar

Form -AD

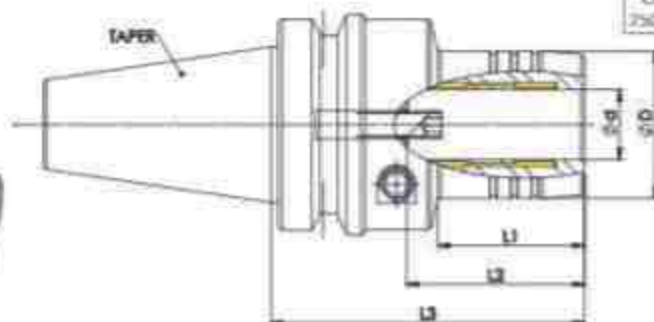
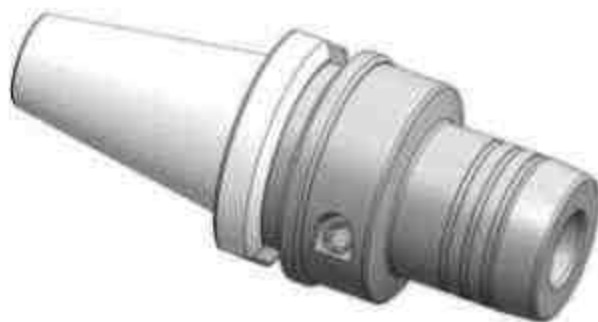

Taper	Ordering Code	d	D	L1	L2	L3	Wt. in Kgs.
BT 30	512.030.38.06.70	6	26	70	37	23	0.7
	512.030.38.08.70	8	28	70	37	24	0.7
	512.030.38.10.80	10	30	80	41	30	0.7
	512.030.38.12.85	12	32	85	46	40	0.7
	512.030.38.14.90	14	34	90	46	40	0.8
	512.030.38.16.90	16	38	90	49	28	0.9
	512.030.38.20.100	20	42	100	51	28	0.9
BT 40	512.040.38.06.70	6	26	70	37	23	1.3
	512.040.38.08.70	8	28	70	37	24	1.3
	512.040.38.10.80	10	30	80	41	30	1.4
	512.040.38.12.85	12	32	85	46	40	1.5
	512.040.38.14.90	14	34	90	46	40	1.5
	512.040.38.16.90	16	38	90	49	28	1.7
	512.040.38.20.100	20	42	100	51	28	1.7
	512.040.38.25.110	25	58	110	57	50	2.2
	512.040.38.32.110	32	60	110	61	-	2.3
BT 50	512.050.38.06.75	6	26	75	37	23	4.1
	512.050.38.08.75	8	28	75	37	24	4.1
	512.050.38.10.90	10	30	90	41	30	4.2
	512.050.38.12.95	12	32	95	46	40	4.1
	512.050.38.14.95	14	34	95	46	40	4.1
	512.050.38.16.100	16	38	100	49	45	4.3
	512.050.38.20.105	20	42	105	51	43	4.6
	512.050.38.25.110	25	58	110	57	50	5.0
	512.050.38.32.110	32	64	110	61	60	5.1

Accessories

HydNar Sleeve

Flange Flange through Coolant Available on Request
 Special Designs and Sizes are Available on Request



HSK-A Hydraulic Clamping Tool Holders - HydNar

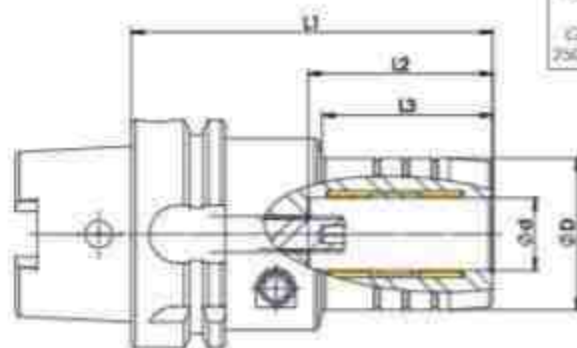

Taper	Ordering Code	d	D	L1	L2	L3	Wt. in Kgs.
HSK A50	511.050.38.06.70	6	26	70	37	23	0.6
	511.050.38.08.70	8	28	70	37	24	0.6
	511.050.38.10.80	10	30	80	41	30	0.7
	511.050.38.12.85	12	32	85	46	40	0.7
	511.050.38.14.90	14	34	90	46	40	0.8
	511.050.38.16.90	16	38	90	49	28	0.8
	511.050.38.20.100	20	42	100	51	28	1
HSK A63	511.063.38.06.70	6	26	70	37	23	1
	511.063.38.08.70	8	28	70	37	24	1.0
	511.063.38.10.80	10	30	80	41	30	1.1
	511.063.38.12.85	12	32	85	46	40	1.1
	511.063.38.14.90	14	34	90	46	40	1.1
	511.063.38.16.90	16	38	90	49	28	1.2
	511.063.38.20.100	20	42	100	51	28	1.4
	511.063.38.25.110	25	58	110	57	50	1.8
	511.063.38.32.110	32	60	110	61	-	1.9
HSK A100	511.100.38.06.75	6	26	75	37	23	2.5
	511.100.38.08.75	8	28	75	37	24	2.5
	511.100.38.10.90	10	30	90	41	30	2.8
	511.100.38.12.95	12	32	95	46	40	2.7
	511.100.38.14.95	14	34	95	46	40	2.7
	511.100.38.16.100	16	38	100	49	45	3.0
	511.100.38.20.105	20	42	105	51	43	3
	511.100.38.25.110	25	58	110	57	50	3.7
	512.100.38.32.110	32	64	110	61	60	3.7

Accessories



HydNar Sleeve

Note: DIN 69893-1 HSK Form-B,C,D,E,F, Tool Holders are Available on Request
Special Designs and Sizes are Available on Request.



HydNar Sleeve



ID	12	20	25	32
3	HGS 12-3	HGS 20-3	HGS 25-3	HGS 32-3
4	HGS 12-4	HGS 20-4	HGS 25-4	HGS 32-4
5	HGS 12-5	HGS 20-5	HGS 25-5	HGS 32-5
6	HGS 12-6	HGS 20-6	HGS 25-6	HGS 32-6
8	HGS 12-8	HGS 20-8	HGS 25-8	HGS 32-8
10		HGS 20-10	HGS 25-10	HGS 32-10
12		HGS 20-12	HGS 25-12	HGS 32-12
14		HGS 20-14	HGS 25-14	HGS 32-14
16		HGS 20-16	HGS 25-16	HGS 32-16
20			HGS 25-20	HGS 32-20
25				HGS 32-25

Overview

'Matching the right technology to a given application is the art of metalworking'

HydNar holder design assures easy and secure tool clamping. The simplicity of assembling the tool with a turn of 'T' wrench saves more time. Runout accuracy will be phenomenal due to the self concentricity done by the expanding internal sleeve and in result, HydNar holders are more suitable to use in high precision machining applications of Aerospace, Automotive, Medical and Die & Mould Industries.

Operating Principle

The hydraulic tool holder works by using gel to expand a sleeve to secure a cutting tool. A close fit between the cutter and the sleeve increases the gripping power. The expansion sleeve is actuated in all directions by the hydraulic gel and tends to center the cutter. Good concentricity between the tool holder and the cutter is necessary for reduced runout of the tool tip—especially critical in higher speed applications.

Key Features





TOOL CLAMPING DEVICE



Taper	Ordering Code
BT 30	517.512.030
BT 40	517.512.040
BT 50	517.512.050
HSK A50	517.511.050
HSK A63	517.511.063
HSK A100	517.511.100

SPANNER



ER	Ordering Code
ER 11	611.07.11
ER 16	611.07.16
ER 20	611.07.20
ER 25	611.07.25
ER 32	611.07.32
ER 40	611.07.40
ER 50	611.07.50

KEY LESS DRILL CHUCK



Clamping Capacity	Ordering Code
0.8 - 13	611.20.JTA6
0.8 - 13	611.20.B16

HSK ACCESSORIES

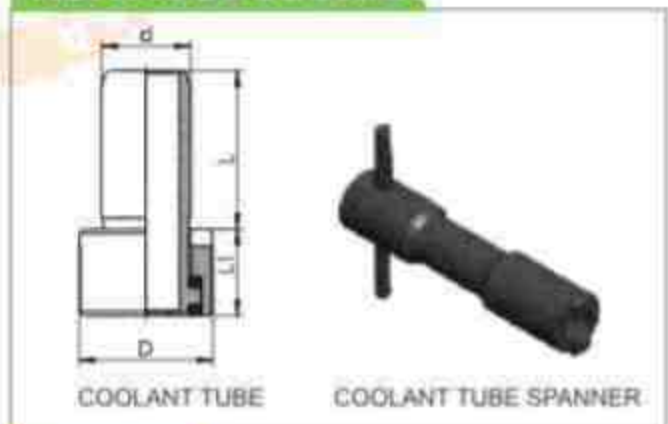

Ordering Code	Taper HSK	D	d	L	L1
611.25.050	50	M16x1	10	32.9	9.6
611.25.063	63	M18x1	12	36.2	11.5
611.25.100	100	M24x1.5	16	43.6	15.7
611.26.050	Ordering Code for spanner				
611.26.063					
611.26.100					



PULL STUD

Pull Stud - BT MAS 403

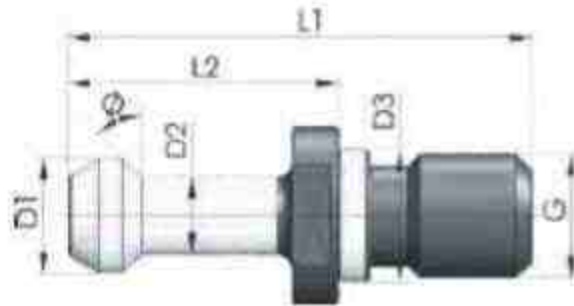

Fig -1

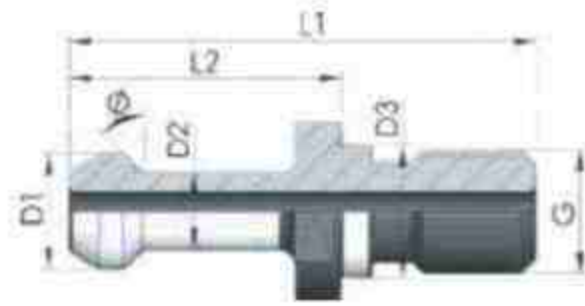

Fig -2

Ordering Code	Taper	G	D1	D2	D3	L2	L1	Ø	FG
520.100.30.45	30	M12	11	7	12.5	23	43	45	1
520.100.30.45TC	30	M12	11	7	12.5	23	43	45	2
520.100.30.30	30	M12	11	7	12.5	23	43	30	1
520.100.30.30TC	30	M12	11	7	12.5	23	43	30	2
520.100.40.45	40	M16	15	10	17	35	60	45	1
520.100.40.45TC	40	M16	15	10	17	35	60	45	2
520.100.40.30	40	M16	15	10	17	35	60	30	1
520.100.40.30TC	40	M16	15	10	17	35	60	30	2
520.100.40.0	40	M16	15	10	17	35	60	0	1
520.100.40.0TC	40	M16	15	10	17	35	60	0	2
520.100.50.45	50	M24	23	17	25	45	85	45	1
520.100.50.45TC	50	M24	23	17	25	45	85	45	2
520.100.50.30	50	M24	23	17	25	45	85	30	1
520.100.50.30TC	50	M24	23	17	25	45	85	30	2
520.100.50.0	50	M24	23	17	25	45	85	0	1
520.100.50.0TC	50	M24	23	17	25	45	85	0	2

Note Special Pull Stud Designs & Sizes are Available on Request



Pull Stud - DIN 69872

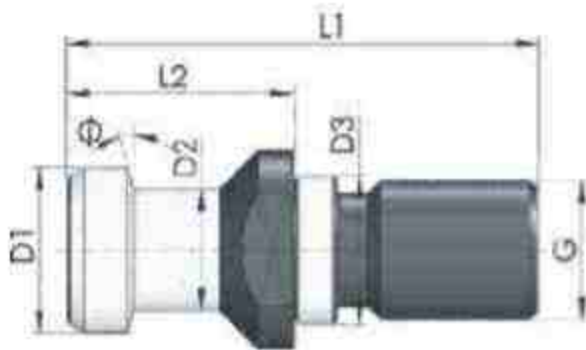

Fig -1

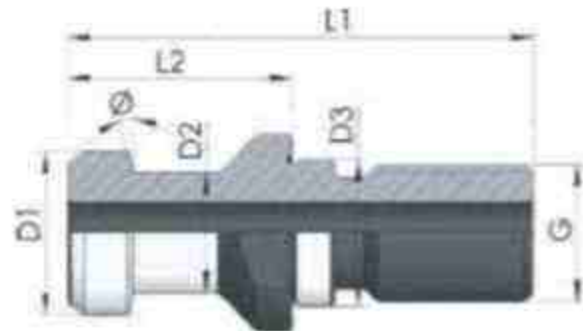

Fig -2

Ordering Code	Taper	G	D1	D2	D3	L2	L1	Ø	FIG
520.101.30.15	30	M12	13	9	12.5	24	44	15	1
520.101.40.15	40	M16	19	14	17	26	54	15	1
520.101.45.15	45	M20	23	17	21	30	65	15	1
520.101.50.15	50	M24	28	21	25	34	74	15	1
520.101.40.15 TC	40	M16	19	14	17	26	54	15	2
520.101.45.15 TC	45	M20	23	17	21	30	65	15	2
520.101.50.15 TC	50	M24	28	21	25	34	74	15	2

Pull Stud - JIS B 6339

Ordering Code	Taper	G	D1	D2	D3	L2	L1	Ø	FIG
520.102.30.15	30	M12	12	8	12.5	23.4	43	15	1
520.102.40.15	40	M16	19	14	17	29	57	15	1
520.102.50.15	50	M24	28	21	25	34	74	15	1
520.102.40.15 TC	40	M16	19	14	17	29	57	15	2
520.102.50.15 TC	50	M24	28	21	25	34	74	15	2

Note: Special Pull Stud Designs & Sizes are Available on Request



COLLET

Collet - DIN 6499



Range	ER 16	ER 20	ER 25	ER 32	ER 40
1.0 - 0.5	522.01.16.010				
2 - 1	522.01.16.020	522.01.20.020	522.01.25.020		
3 - 2	522.01.16.030	522.01.20.030	522.01.25.030	522.01.32.030	
4 - 3	522.01.16.040	522.01.20.040	522.01.25.040	522.01.32.040	522.01.40.040
5 - 4	522.01.16.050	522.01.20.050	522.01.25.050	522.01.32.050	522.01.40.050
6 - 5	522.01.16.060	522.01.20.060	522.01.25.060	522.01.32.060	522.01.40.060
7 - 6	522.01.16.070	522.01.20.070	522.01.25.070	522.01.32.070	522.01.40.070
8 - 7	522.01.16.080	522.01.20.080	522.01.25.080	522.01.32.080	522.01.40.080
9 - 8	522.01.16.090	522.01.20.090	522.01.25.090	522.01.32.090	522.01.40.090
10 - 9	522.01.16.100	522.01.20.100	522.01.25.100	522.01.32.100	522.01.40.100
11 - 10		522.01.20.110	522.01.25.110	522.01.32.110	522.01.40.110
12 - 11		522.01.20.120	522.01.25.120	522.01.32.120	522.01.40.120
13 - 12		522.01.20.130	522.01.25.130	522.01.32.130	522.01.40.130
14 - 13			522.01.25.140	522.01.32.140	522.01.40.140
15 - 14			522.01.25.150	522.01.32.150	522.01.40.150
16 - 15			522.01.25.160	522.01.32.160	522.01.40.160
17 - 16				522.01.32.170	522.01.40.170
18 - 17				522.01.32.180	522.01.40.180
19 - 18				522.01.32.190	522.01.40.190
20 - 19				522.01.32.200	522.01.40.200
21 - 20					522.01.40.210
22 - 21					522.01.40.220
23 - 22					522.01.40.230
24 - 23					522.01.40.240
25 - 24					522.01.40.250
26 - 25					522.01.40.260

 Tap Collet, Sealed Collet, ER8, ER11, ER 50 available on request.



Cylindrical Collet Chuck Holder

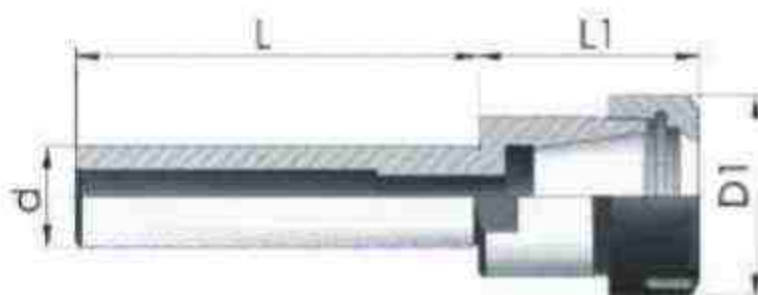

Ordering Code	Suitable Collet	Clamping Range	d	D1	L	L1	Spanner	wt in Kgs.
523.12.01.011.100	ER11	0.5 - 7	12	19	100	35	611.07.11	0.1
523.16.01.011.150	ER11	0.5 - 7	16	19	150	35	611.07.11	0.2
523.16.01.016.100	ER16	0.5 - 10	16	28	100	40	611.07.16	0.2
523.16.01.016.150	ER16	0.5 - 10	16	28	150	40	611.07.16	0.3
523.20.01.020.100	ER20	1 - 13	20	34	100	42	611.07.20	0.3
523.20.01.020.150	ER20	1 - 13	20	34	150	42	611.07.20	0.4
523.25.01.025.100	ER25	1-16	25	42	100	50	611.07.25	0.5
523.25.01.025.150	ER25	1-16	25	42	150	50	611.07.25	0.6

Morse Taper Collet Chuck Holder - Tanged End

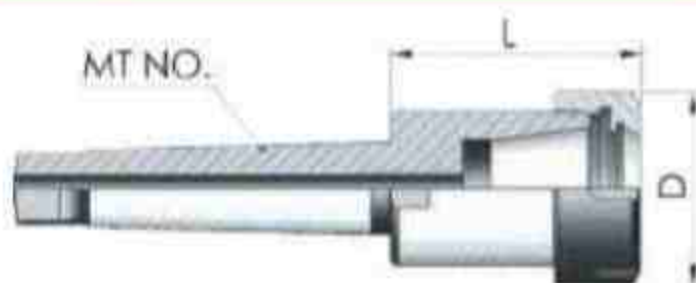

Taper	Ordering Code	Suitable Collet	Clamping Range	D	L	Spanner	wt in Kgs.
MTA 3	525.03.01.032.070	ER 32	2-20	50	70	611.07.32	0.8
	525.03.01.040.075	ER 40	3-26	63	75	611.07.40	1
MTA 4	525.04.01.032.075	ER 32	2-20	50	75	611.07.32	1.1
	525.04.01.040.075	ER 40	3-26	63	75	611.07.40	1.3

Note: Spanner Order Separately
Special Designs and Sizes are Available on Request



SHRINK FIT Cylindrical Extension

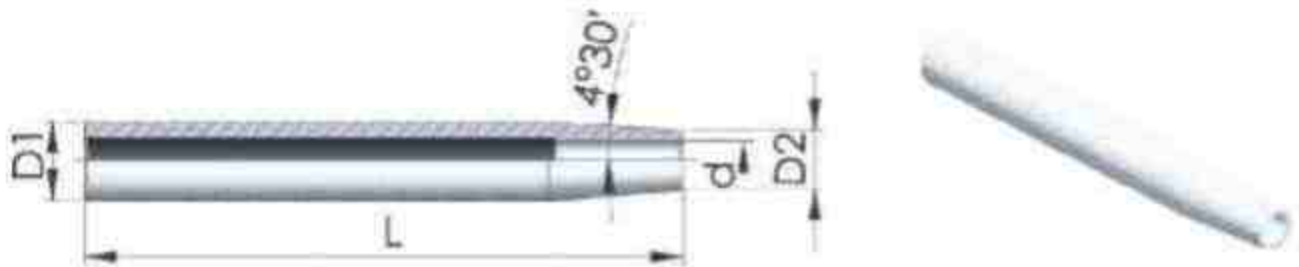

Ordering Code	d	D1	D2	L	Wt in Kgs
523.16.05.06.160	6	16	10	160	0.2
523.16.05.08.160	8	16	14	160	0.2
523.20.05.06.160	6	20	14	160	0.3
523.20.05.08.160	8	20	14	160	0.3
523.20.05.10.160	10	20	16	160	0.3
523.25.05.06.160	6	25	14	160	0.4
523.25.05.08.160	8	25	19	160	0.5
523.25.05.10.160	10	25	20	160	0.5
523.25.05.12.160	12	25	20	160	0.5
523.25.05.14.160	14	25	20	160	0.5
523.25.05.16.160	16	25	22	160	0.3
523.32.05.10.160	10	32	27	160	0.9
523.32.05.12.160	12	32	27	160	0.8
523.32.05.14.160	14	32	27	160	0.8
523.32.05.16.160	16	32	27	160	0.7
523.32.05.20.160	20	32	27	160	0.6

Note: Special Designs and Sizes are Available on Request



Anti Vibration - Back Facing /
Boring Tool



Bridge Type Combination
Rough & Finish Boring Bar



Combination Boring Bar
(with ISO Cartridge)



Combination Rough Boring Bar



Drill with Guide Pad



Combination OD Turning Tool



Combination Finish Boring Bar



BT Extra Length Holder



FEMCO Holders



CUSTOMIZED TOOLS



NT50 Holders



Bridge Type ID Finish Boring Bar



OD Finish Boring Bar



Trepanning Tool



Special Mounts



Front & Back Spot Facing Tool



Combination Rough & Finish Boring Bar



Run-out Adjustable Holders



Grooving Cutter





NARITAA TOOLING PRIVATE LIMITED

Mfrs.: CNC Tool holding Systems & Boring Bars

No. 16/3 Lakshmi Thottam, Lakshmpuram Back Side,
Chinnavedampatti, Maniyakaranpalayam Road,
Coimbatore - 641 049, Tamil Nadu, INDIA.

Phone : + 91 422 4349842 Mobile : + 91 98420 05552

E-mail : sales@naritaatooling.in / ps@naritaatooling.in

Web : www.naritaatooling.in

 [Naritaa Tooling Private Limited](https://www.naritaatooling.in)
 [Naritaa Tooling](https://www.facebook.com/naritaatooling)
 [naritaa_tool](https://www.instagram.com/naritaatooling)

