



NARITAA

B O R I N G B A R S



PRODUCT
CATALOGUE





BORING BARS

BASIC HOLDER - HSK (DIN 69893)

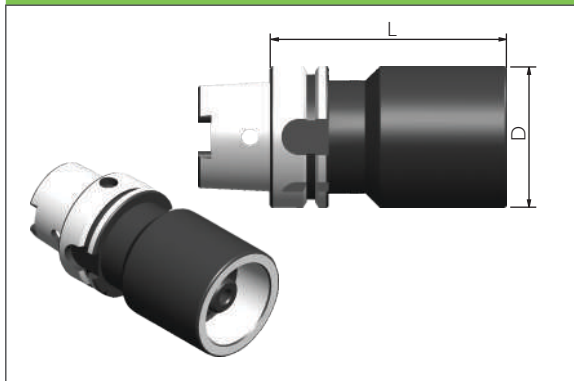

Taper	Ordering Code	D	L	WT. in Kgs.
63	511H.063.00.050.090	50	90	1.2
63	511H.063.00.063.105	63	105	2.1
63	511H.063.00.100.130	100	130	5.6
100	511H.100.00.050.100	50	100	3.0
100	511H.100.00.063.115	63	115	3.7
100	511H.100.00.100.135	100	135	6.5

BASIC HOLDER - BT MAS 403 (JIS 6339)

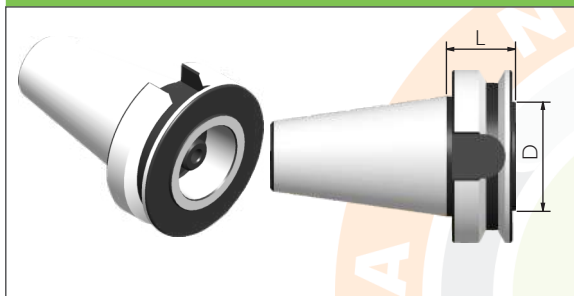

Taper	Ordering Code	D	L	WT. in Kgs.
40	512H.040.00.050.040	50	040	1.1
40	512H.040.00.063.060	63	060	1.4
50	512H.050.00.050.038	50	038	3.6
50	512H.050.00.063.038	63	038	3.3
50	512H.050.00.100.100	100	100	5.6

BASIC HOLDER - BBT / DUAL CONT.



Taper	Ordering Code	D	L	WT. in Kgs.
40	516H.040.00.050.040	50	040	1.1
40	516H.040.00.063.060	63	060	1.4
50	516H.050.00.050.038	50	038	3.6
50	516H.050.00.063.038	63	038	3.3
50	516H.050.00.100.100	100	100	5.6

BASIC HOLDER - SK (DIN 69871)

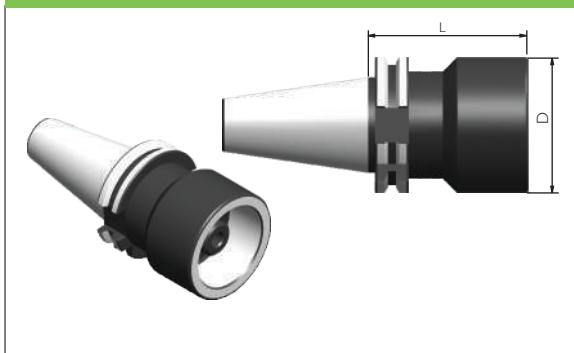

Taper	Ordering Code	D	L	WT. in Kgs.
40	513H.040.00.050.040	50	040	1.1
40	513H.040.00.063.075	63	075	1.6
50	513H.050.00.050.030	50	030	2.9
50	513H.050.00.063.030	63	030	2.5
50	513H.050.00.100.095	100	095	5.3

Note : Other spindle taper are available on request

BASIC HOLDER - CAT (ANSI B5.50)

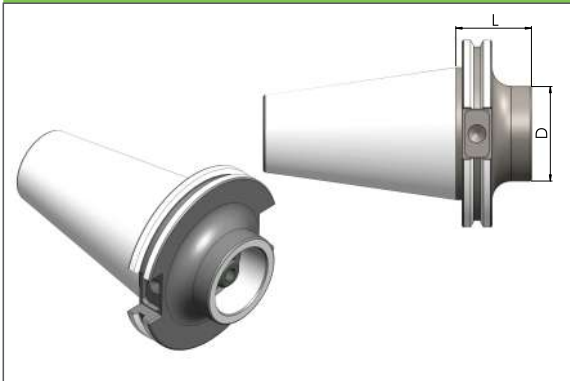

Taper	Ordering Code	D	L	WT. in Kgs.
40	514H.040.00.050.040	50	40	1.1
40	514H.040.00.063.075	63	75	1.6
50	514H.050.00.050.038	50	38	2.9
50	514H.050.00.063.038	63	38	2.5
50	514H.050.00.100.100	100	100	5.3

Flange Type Face Mill Arbor - HSK (DIN 69893)

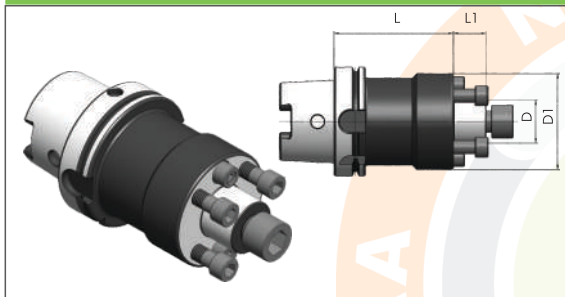

Taper	Ordering Code	D	D1	L	L1	Wt. in Kgs.
HSK A63	511.063.03.040.075.H	40	95	75	30	2.3
HSK A100	511.100.03.040.075.H	40	95	75	30	3.9

Flange Type Face Mill Arbor - BT MAS 403 (JIS B 6339) / BBT

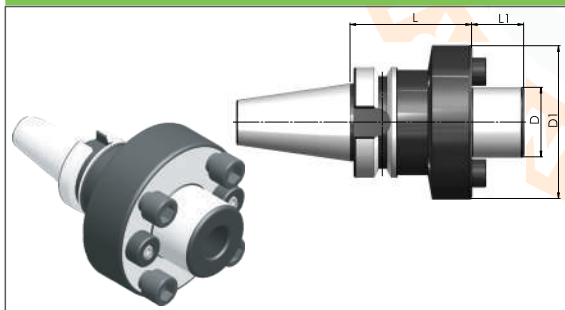

Taper	Ordering Code	D	D1	L	L1	Wt. in Kgs.
BT						
40	512.040.03.040.075.H	40	95	75	30	2.6
50	512.050.03.040.075.H	40	95	75	30	5.7
BBT						
40	516.040.03.040.075.H	40	95	75	30	2.6
50	516.050.03.040.075.H	40	95	75	30	5.7

Other Tapers are available on request

EXTENSION

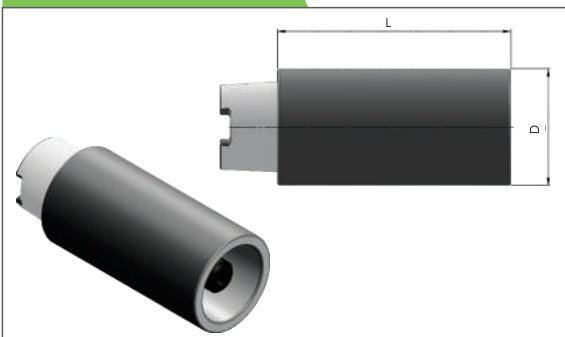

Ordering Code	D	L	WT. in Kgs.
518H.050.13.050.075	50	75	1.1
518H.050.13.050.100	50	100	1.4
518H.063.13.063.075	63	75	1.8
518H.063.13.063.100	63	100	2.3
518H.100.13.100.100	100	100	5.5

FINE BORING - HEAD

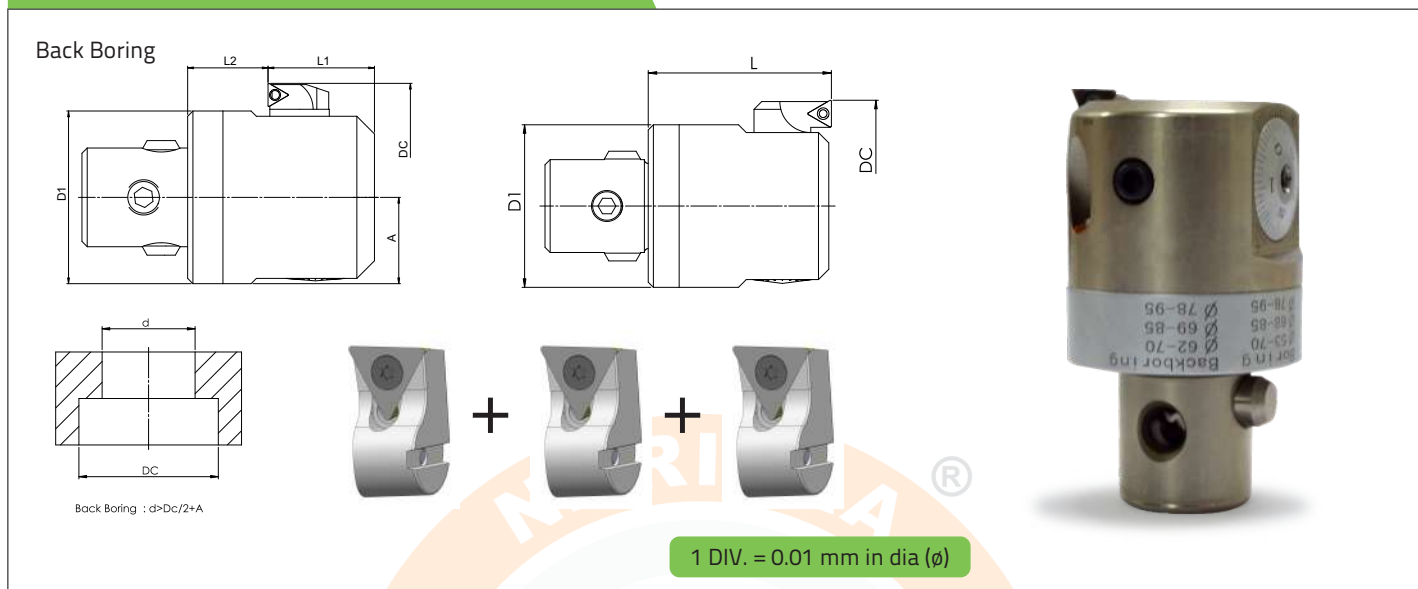

Ordering Code	BORING				BACK BORING				Cartridge	insert Size	WT. in Kgs.
	DC	D1	L	Cartridge	DC	L1	L2	A			
NBH1-FBH2036-32.5	20-26	19	32.5	FBH1 - 1		20	10	10			
	25-31			FBH1 - 2	30 - 31				FBH1 - 2	TP 0802	0.09
	30-36			FBH1 - 3	30 - 36				FBH1 - 3		
NBH2-FBH2547-35.5	25-33	24	35.5	FBH2 - 1		22	10	12.5			
	32-40			FBH2 - 2	36-40				FBH2 - 2	TP 0802	0.15
	39-47			FBH2 - 3	39-47				FBH2 - 3		
NBH3-FBH3260-40	32-42	31	40	FBH3 - 1		25	9	16			
	41-51			FBH3 - 2	46-51				FBH3 - 2	TP 0802	0.25
	50-60			FBH3 - 3	50-60				FBH3 - 3		
NBH4-FBH4174-47	41-54	39	47	FBH4 - 1		30	13	20	FBH4 - 1	TC 1102 /	0.43
	53-66			FBH4 - 2	58-66				FBH4 - 2	TP 1103	
	61-74			FBH4 - 3	61-74				FBH4 - 3		
NBH5-FBH5395-57	53-70	49	57	FBH5 - 1	62-70	34	19	25.5	FBH5 - 1	TC 1102 /	
	68-85			FBH5 - 2	69-85				FBH5 - 2	TP 1103	1.25
	78-95			FBH5 - 3	78-95				FBH5 - 3		
NBH6-FBH68150-71	68-100	63	71	FBH6 - 1	80-100	45	23	32.5	FBH6 - 1	TC 1102/	1.78
	93-125			FBH6 - 2	93-125				FBH6 - 2	TP 1103	
	125-150			FBH6 - 3	125-150				FBH6 - 3		
NBH6-FBH100203-71	100-153	63	71	FBH6 - 1	112-153	45	23	45.5	FBH6 - 1	TC 1102/	2.53
	125-178			FBH6 - 2	125-178				FBH6 - 2	TP 1103	
	150-203			FBH6 - 3	150-203				FBH6 - 3		

MODULAR ROUGH BORING BAR

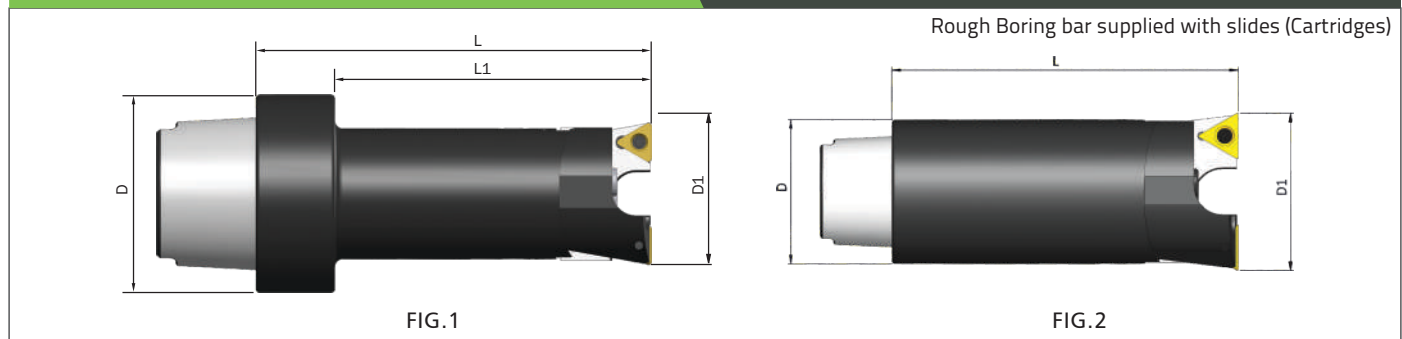

Ordering Code	Boring range D1	D	L	L1	Slide No.	Insert Type	Fig. No.	WT. in Kgs.
518H.050.15.025.090	25 - 32	50	90	70	611.28.025.CC 06	CCMT 06 02 08	1	0.7
518H.050.15.030.110	30 - 38	50	110	90	611.28.030.CC 06	CCMT 06 02 08	1	0.7
518H.050.15.037.110	37 - 47	50	110	90	611.28.037.TC 11	TCMT 11 02 08	1	0.9
518H.050.15.046.110	46 - 56	50	110	90	611.28.046.TC 16	TCMT 16 T3 08	1	1.2
518H.050.15.055.085	55 - 70	50	85	-	611.28.055.TC 16	TCMT 16 T3 08	1	1.1
518H.063.15.069.090	69 - 85	63	90	-	611.28.069.TC 16	TCMT 16 T3 08	2	1.9
	83 - 100	63	90	-	611.28.083.TC 16	TCMT 16 T3 08	2	2.0
518H.063.15.099.125	99 - 126	100	125	105	611.28.099.TC 16	TCMT 16 T3 08	2	4.2
	123 - 150	100	125	-	611.28.123.TC 16	TCMT 16 T3 08	2	1.2
518H.100.15.148.125	148 - 190	100	125	-	611.28.148.TC 16	TCMT 16 T3 08	2	6.6
	188 - 230	100	125	-	611.28.188.TC 16	TCMT 16 T3 08	2	7.1
	228 - 270	100	125	-	611.28.228.TC 16	TCMT 16 T3 08	2	7.7

Note : CCMT Insert available on request

MODULAR FINISH BORING BAR

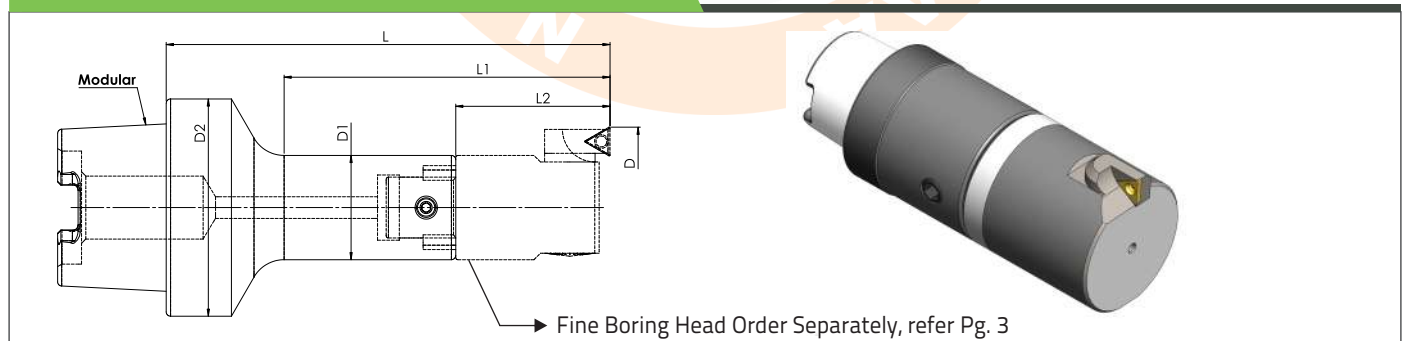

Ordering Code	Boring range D	D1	D2	L	L1	L2	WT. in Kgs.
518H.050.NBH1.20.105	20-36	19	50	105	78	32.50	0.60
518H.050.NBH2.25.142	25-47	24	50	142	102	35.50	0.70
518H.050.NBH3.32.121	32-60	31	50	121	96	40	1.00
518H.050.NBH4.41.110	41-74	39	50	110	89	47	1.20
518H.050.NBH5.53.110	53-95	49	50	110	94	57	1.70
518H.063.NBH6.68.126	68-150	63	63	126	126	71	3.20
518H.063.NBH6.100.136	100-203	90	63	136	-	71	5.0

BT 30 / BBT 30 INTEGRAL FINISH BORING HOLDER

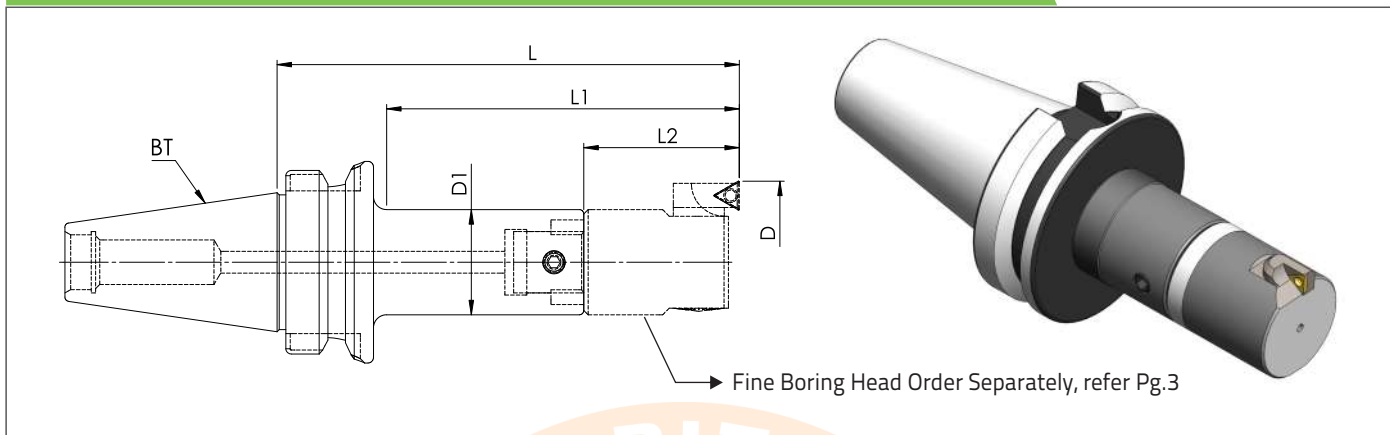

Ordering Code		Boring range D _T	D ₁	L	L ₁	L ₂	WT. in Kgs.
BT	BBT						
512.030.NBH1.080	516.030.NBH1.080	20-36	19.00	80.00	55	32.50	0.50
512.030.NBH2.105	516.030.NBH2.105	25-47	24.00	106.00	80.5	35.50	0.70
512.030.NBH3.120	516.030.NBH3.120	32-60	31.00	120.00	95	40.00	0.90
512.030.NBH4.127	516.030.NBH4.127	41-74	39.00	127.00	103	47.00	1.30

Note : Big bore sizes and extra length boring bars are available on request

HSKA50 INTEGRAL FINISH BORING HOLDER

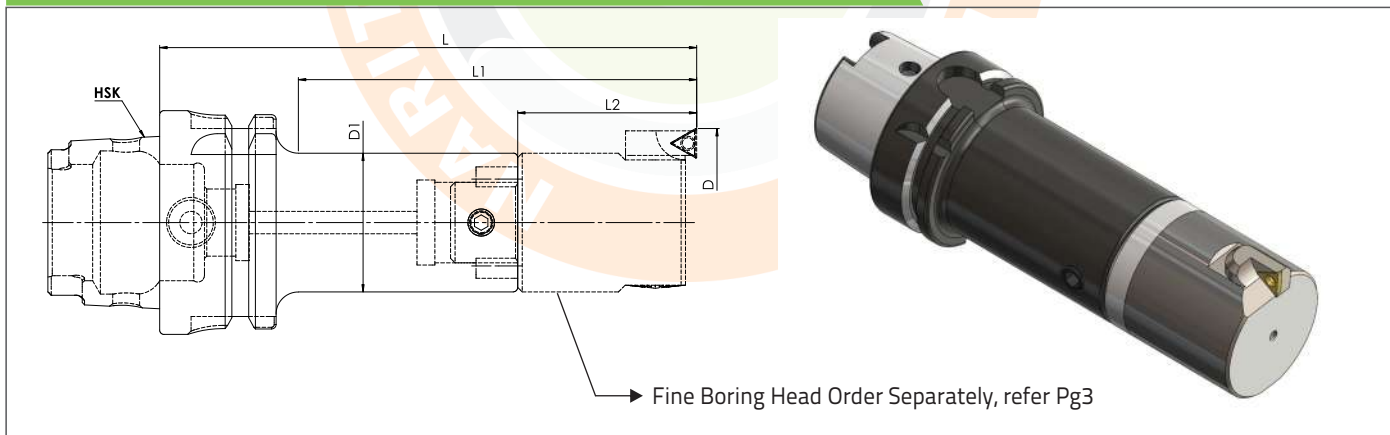

Ordering Code	Boring range D ₁	D	L	L ₁	L ₂	WT. in Kgs.
511.050.NBH1.080	20-36	19.00	112.50	81.50	32.50	0.60
511.050.NBH2.080	25-47	24.00	115.50	84.50	35.50	0.70
511.050.NBH3.080	32-60	31.00	120.00	89.00	40.00	0.90
511.050.NBH4.080	41-74	39.00	127.00	98.00	47.00	0.80

Note : Big bore sizes and extra length boring bars are available on request

MODULAR ADJUSTABLE HEAVY DUTY FINISH BORING BAR

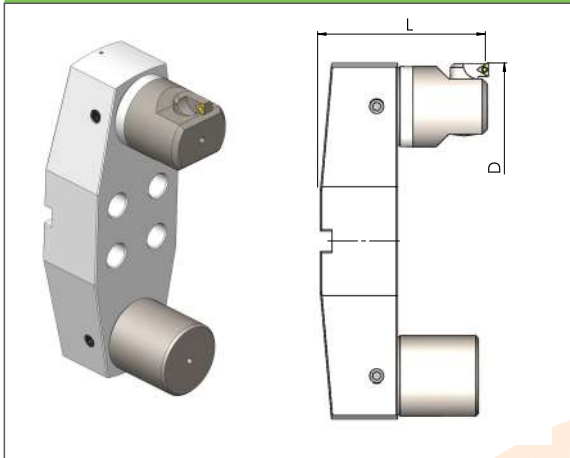

Boring Range D	Ordering Code	L	WT. in Kgs.	Insert Type
200 - 280	529.040.16.200.131	131	5.6	
280 - 360	529.040.16.280.131	131	6.5	
360 - 440	529.040.16.360.131	131	7.6	TP 11 02 /
440 - 520	529.040.16.440.131	131	8.7	TC 11 02
520 - 600	529.040.16.520.131	131	9.7	
600 - 680	529.040.16.600.131	131	10.6	
680 - 760	529.040.16.680.131	131	13.8	

MODULAR ADJUSTABLE HEAVY DUTY ROUGH BORING BAR

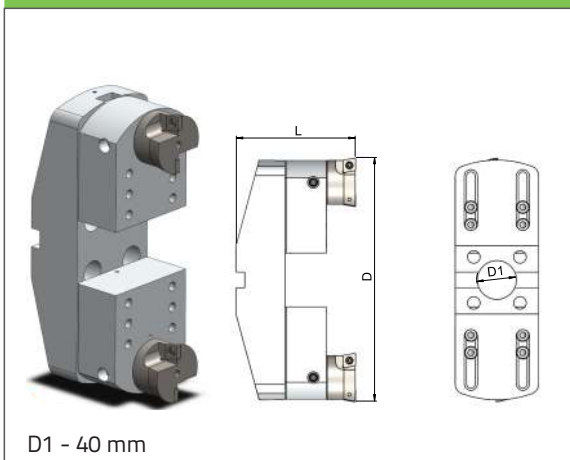

D1 - 40 mm

Boring Range D	Ordering Code	L	WT. in Kgs.	Insert Type
200 - 250	529.040.15.200.122	122	3.4	
250 - 300	529.040.15.250.122	122	4.1	
300 - 350	529.040.15.300.122	122	4.6	
350 - 400	529.040.15.350.122	122	4.9	
400 - 450	529.040.15.400.122	122	5.3	CCMT
450 - 500	529.040.15.450.122	122	5.9	12 04 08
500 - 550	529.040.15.500.122	122	6.2	
550 - 600	529.040.15.550.122	122	6.6	
600 - 650	529.040.15.600.122	122	6.8	
650 - 700	529.040.15.650.122	122	7.6	
700 - 750	529.040.15.700.122	122	8	

*Specifications are subject to change without prior notice due to continuous development.

SMALL DIAMETER PRECISION BORING BAR

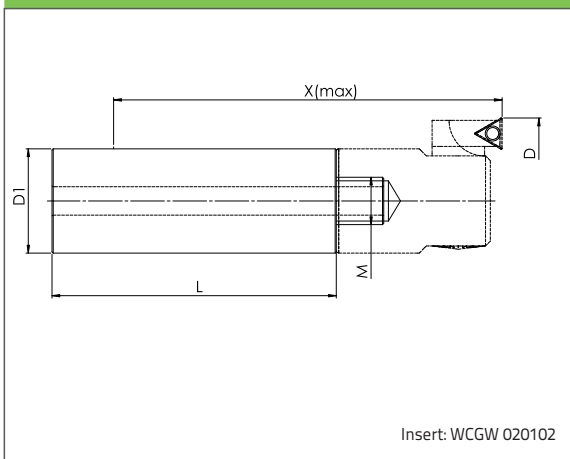

Insert: WCGW 020102

Boring Range D	Ordering Code	D1	M	L	X (Max)
15 - 18.5	536.41.15.087	14	M6	87	82
	536.41.15.117	14	M6	117	112
	536.41.15.147	14	M6	147	142
18 - 22	536.41.18.088	16	M10	88	89
	536.41.18.108	16	M10	108	109
	536.41.18.168	16	M10	168	169

*Specifications are subject to change without prior notice due to continuous development.



BORING BARS

NBH - PRECISION BORING KIT (Dia - 8-50)

1 DIV. = 0.005mm

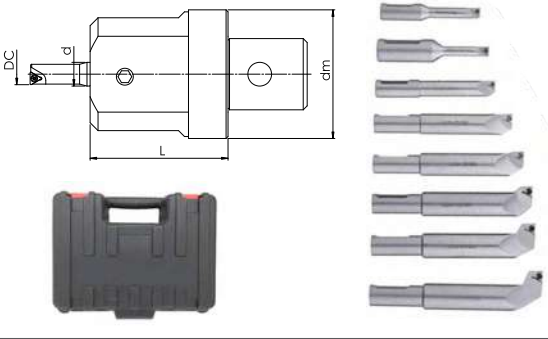

Boring Range - DC	Ordering Code	L
08 - 50	537.41.0850-65	65

Range Split up :

Range	Insert	Range	Insert
8 - 15	TBGT 060102	25 - 32	TPGH 110304L
12 - 19	TPGH 090204L	31 - 38	TPGH 110304L
16 - 23	TPGH 090204L	37 - 44	TPGH 110304L
20 - 27	TPGH 110304L	43 - 50	TPGH 110304L

NBH - PRECISION BORING KIT (Dia 8 -203)

1 DIV. = 0.005mm

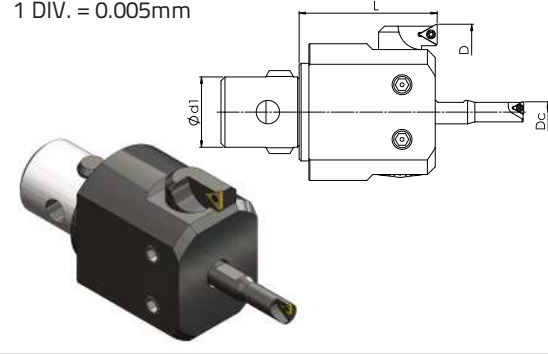

Boring Range - DC	Ordering Code	L
08 - 203	537.41.08203-52	52

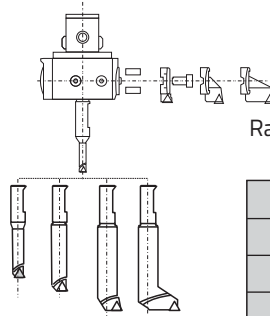

Range Split up :

Range	Insert	Range	Insert
8 - 43	TBGT060102	65 - 100	TBGH110304L
12 - 47	TBGH090204L	100 -135	TP1103
16 - 51	TBGH090204L	134 - 169	TP1103
31 - 66	TBGH090304L	168 - 203	TP1103

OD TURNING - FINISH

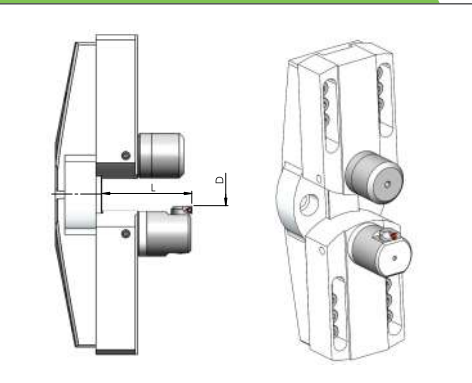

Ordering Code	OD TURNING Range - D	L	Insert Type	WT. in Kgs.
529.040.40.08.078	8 - 55	78	TP 11 02 / TC 11 02	3.7
529.040.40.30.078	30 - 120	78	TP 11 02 / TC 11 02	4

NARITAA TOOLING PRIVATE LIMITED

Mfrs.: CNC Tool holding Systems & Boring Bars

No. 16/3 Lakshmi Thottam, Lakshmiapuram Back Side,
Chinnavedampatti, Maniyakaranpalayam Road,
Coimbatore - 641 049. Tamil Nadu. INDIA.

Phone : + 91 422 4349842 Mobile : + 91 98420 05552
E-mail : sales@naritaatooling.in / ps@naritaatooling.in
Web : www.naritaatooling.in

Naritaa Tooling Private Limited
 Naritaa Tooling
 naritaa_tool

